



**GMV**



Submersible pumps with vortex impeller in cast iron EN-GJL-250 pag. 250

**GMVS**



Submersible pumps with vortex impeller in cast iron with polyurethane coating pag. 257

**GMC**

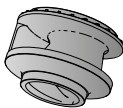

Submersible pumps with single channel impeller in cast iron EN-GJL-250 pag. 259

**GMN**

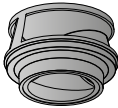

Submersible pumps with channels impeller in cast iron EN-GJL-250 pag. 268

**GMG**



Submersible pumps with grinder in cast iron EN-GJL-250 pag. 282

**I-GMV**



Submersible pumps with vortex impeller in stainless steel AISI316 pag. 286

**I-GMC**



Submersible pumps with single channel impeller in stainless steel AISI316 pag. 286

**I-GMN**



Submersible pumps with channels impeller in stainless steel AISI316 pag. 286

**B-GMV**



Submersible pumps with vortex impeller in Marine Bronze B10 pag. 297

**B-GMC**

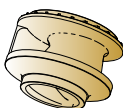

Submersible pumps with single channel impeller in Marine Bronze B10 pag. 297

**B-GMN**



Submersible pumps with channels impeller in Marine Bronze B10 pag. 297

A new series of submersible pumps with high efficiency hydraulics designed to move slurry, sewage and industrial process fluids.

The range covers a wide field of use with head up to 75 m And flows up to 2300 m<sup>3</sup>/h, with a maximum solid passage up to 140 mm keeping the risk of blockage to a minimum. Dimensionally designed for heavy demand, even on critical applications.

Explosion proof version on request.

### Pump designation

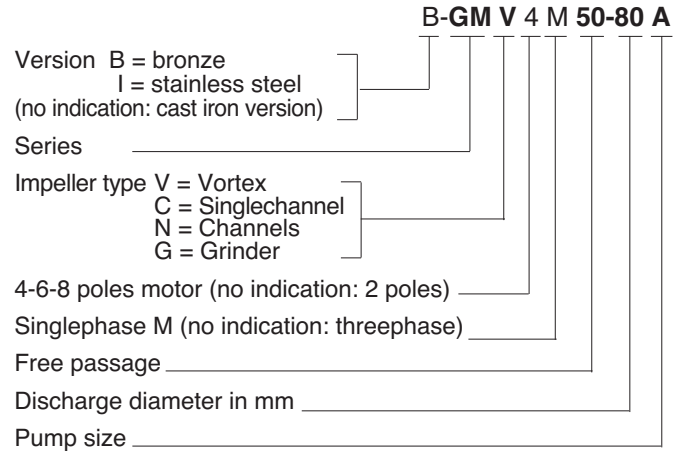

### Coverage chart

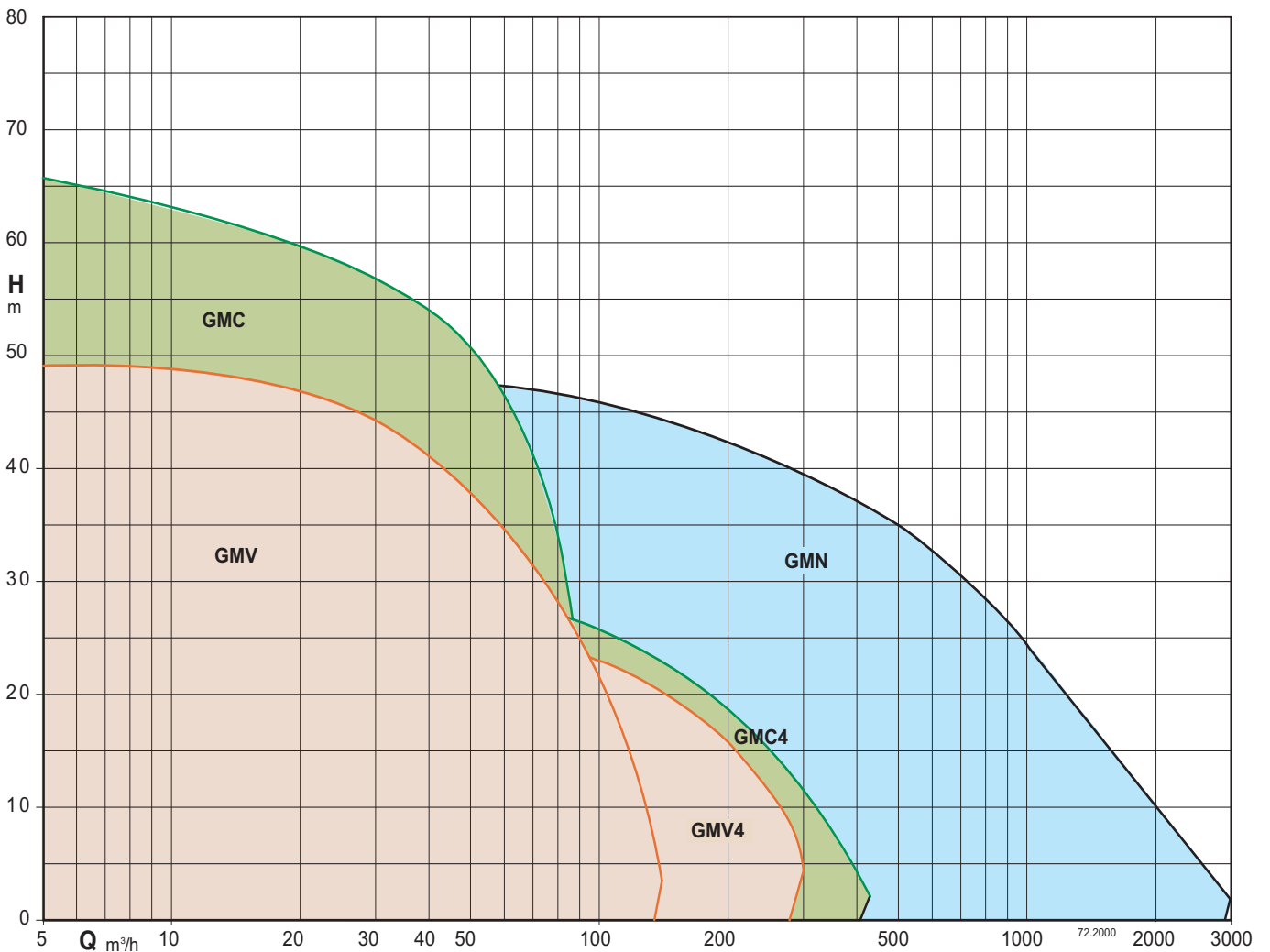

Tolerances according to ISO 9906, annex A.



### Construction

Submersible pumps with high power grinder.  
Twin mechanical seal with oil chamber (lip-seal motor side up to 1,6 kW).  
Delivery connection DN 40.

### Applications

Suitable for pumping waste water containing long filamentous, Paper and textile materials and organics.  
They are particularly suitable for use in domestic, residential and industrial installations  
Solid passage from 6 and 7 mm

### Operating conditions

Liquid temperature up to 40 °C.  
Maximum immersion depth: 20 m (with suitable cable length).  
Continuous duty (with pump immersed at minimum level).

### Main materials

- Pump casing: cast iron EN-GJL-250
- Motor casing: cast iron EN-GJL-250
- Motor cover: cast iron EN-GJL-250
- Impeller: cast iron GS 400
- Shaft : stainless steel AISI 420B
- Lip seal made of nitrile up to 1,6 kW
- Mechanical seal motor side: graphite/ceramic over 1,6 kW
- Mechanical seal pump side: silicon carbide/silicon carbide

### Motor

- 2 poles induction, 50Hz
- Single-phase version: 230V ± 10%, with float switch and control box with thermal protection and starting capacitors.
- Three-phase version: 400V ± 10%, up to 3,2 kW  
400/690V ± 10%, over 3,2 kW
- Insulation class: H
- Protection degree: IP 68
- N° of starting x hour: max 15 with regular intervals
- Cable: H07RN-F, length 10 m
- Other models: contact our sale office

### Coverage chart

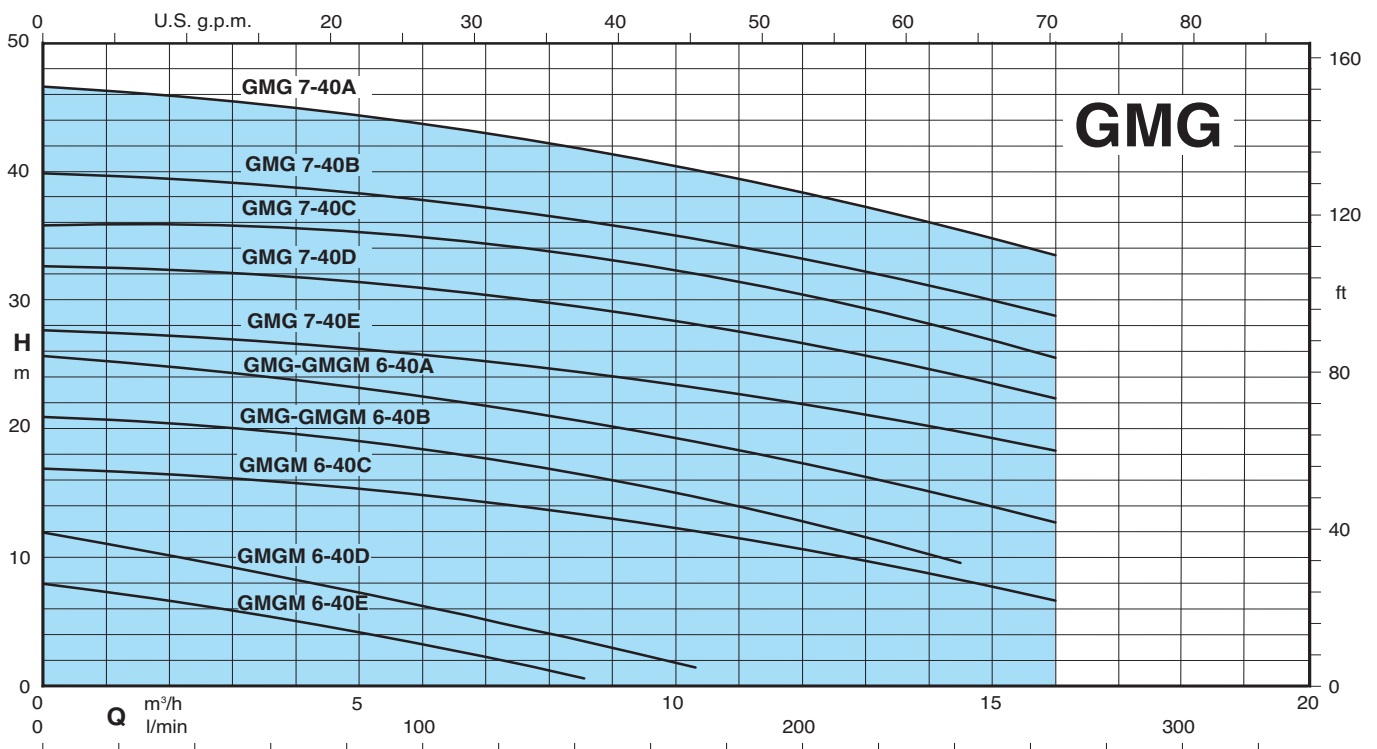

**Technical data**

TYPE	P <sub>2</sub> kW	I <sub>N</sub> A	Power Supply	r.p.m.	Starting	DN mm	Free passage Ø mm	Thermal protector	Humidity probe	ATEX Eex
GMGM 6-40E/A	1,1	7,5	1~ 230V	2850	D.O.L.	40	6	●	NO	
GMGM 6-40D/A	1,1	7,5	1~ 230V	2850	D.O.L.	40	6	●	NO	
GMGM 6-40C	1,1	7,5	1~ 230V	2850	D.O.L.	40	6	●	NO	
GMGM 6-40B	1,1	7,5	1~ 230V	2850	D.O.L.	40	6	●	NO	
GMG 6-40B	1,4	3,5	3~ 400V	2850	D.O.L.	40	6	NO	NO	✓
GMGM 6-40A	1,8	10	1~ 230V	2850	D.O.L.	40	6	●	NO	
GMG 6-40A	2,4	5	3~ 400V	2850	D.O.L.	40	6	NO	NO	✓
GMG 7-40E	3,2	6,5	3~ 400V	2850	D.O.L.	40	7	NO	NO	✓
GMG 7-40D	3,2	6,5	3~ 400V	2850	D.O.L.	40	7	NO	NO	✓
GMG 7-40C	4,1	8,5	3~ 400/690V	2850	Y/Δ	40	7	●	●	✓
GMG 7-40B	5	11	3~ 400/690V	2850	Y/Δ	40	7	●	●	✓
GMG 7-40A	5	11	3~ 400/690V	2850	Y/Δ	40	7	●	●	✓

 P<sub>2</sub> Rated power output

 I<sub>N</sub> Rated current

● Standard

✓ ATEX Eex Version on demand

### Characteristic curves

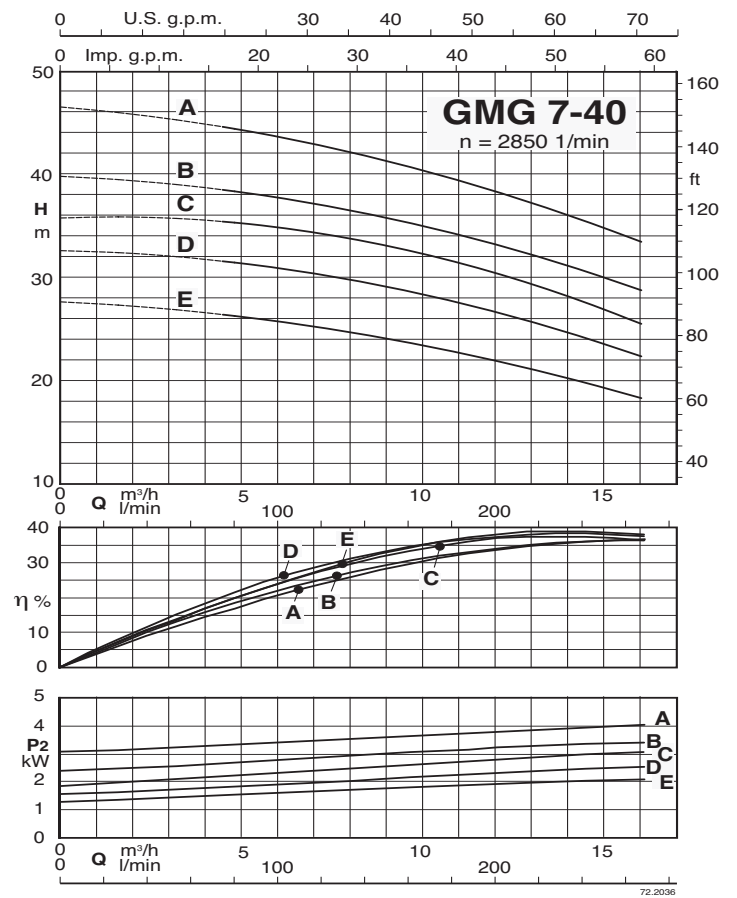
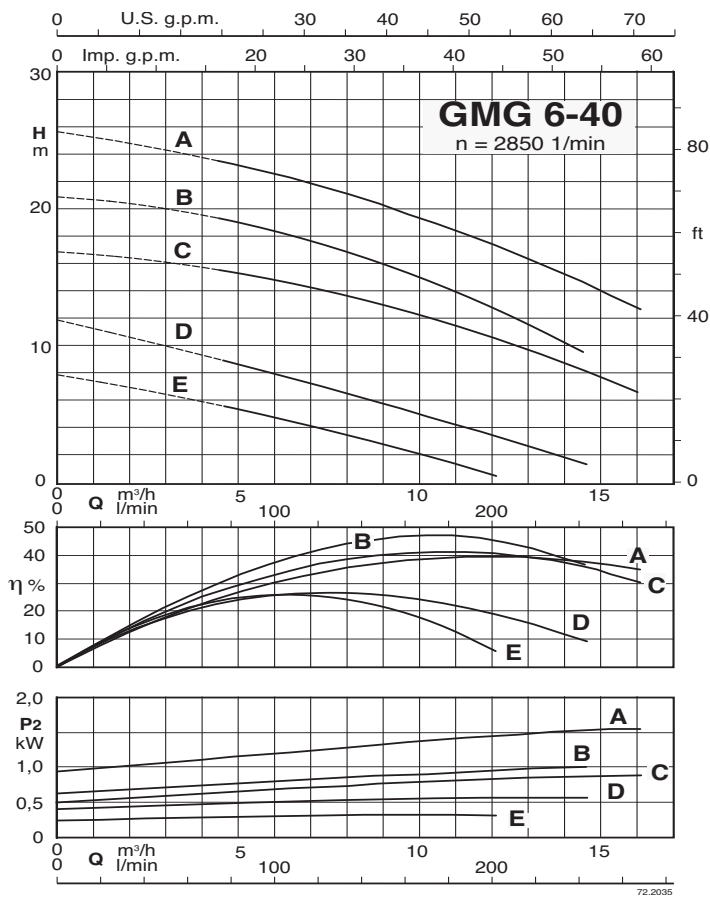

### Dimensions and weights

#### GMGM 6-40D/A, E/A

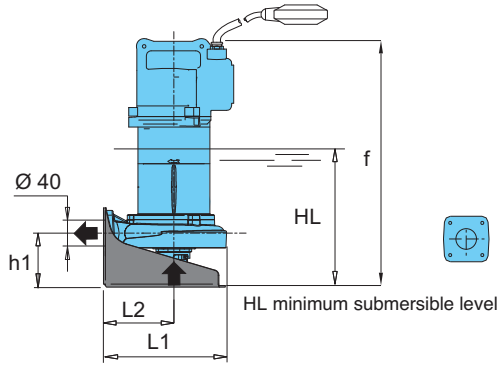

#### GMGM 6-40 GMG 6-40 GMG 7-40

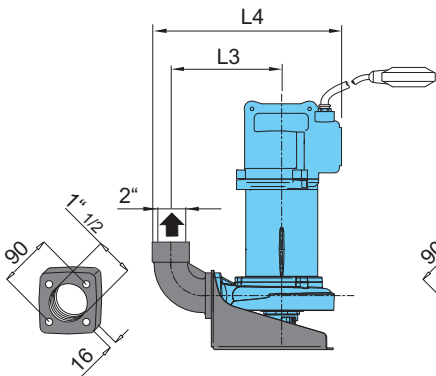
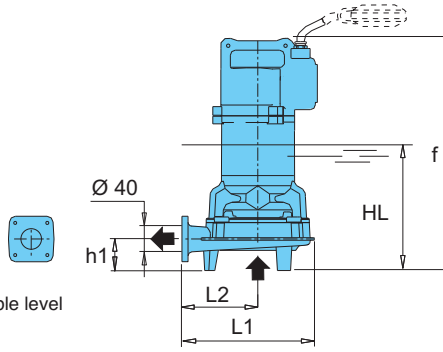

Version with threaded flange and 90° elbow

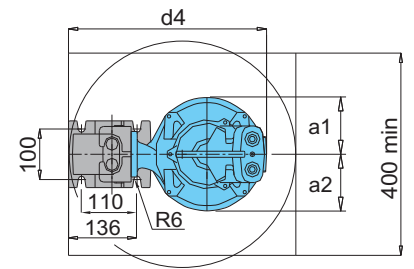
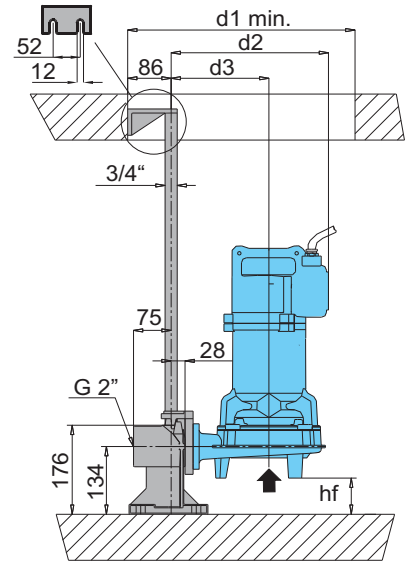
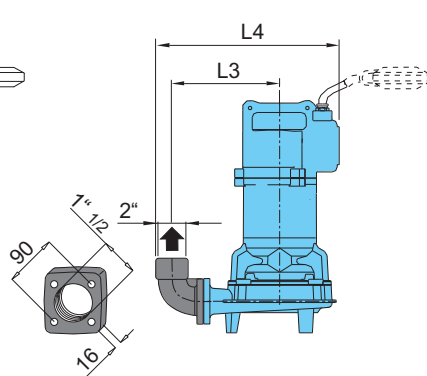

Version with duck foot coupling

TYPE	Dimensions mm															Weight kg
	Ø1	f	HL	hf	h1	a1	a2	d1	d2	d3	d4	L1	L2	L3	L4	
GMGM 6-40E/A	40	441	283	77	106	104	104	450	297	178	392	256	138	154	272	30
GMGM 6-40D/A																
GMGM 6-40C																
GMGM 6-40B																
GMG 6-40B	40	460	240	71	63	112	112	450	312	194	392	268	150	212	262	40
GMGM 6-40A																
GMG 6-40A																
GMG 7-40E																
GMG 7-40D	40	458	315	10	124	121	121	450	327	189	413	288	150	230	405	45
GMG 7-40C																
GMG 7-40B																
GMG 7-40A	40	517	336	10	124	121	121	450	334	189	420	295	150	230	412	60
GMG 7-40A																