



**GMV**



Submersible pumps with vortex impeller in cast iron EN-GJL-250 pag. 250

**GMVS**



Submersible pumps with vortex impeller in cast iron with polyurethane coating pag. 257

**GMC**

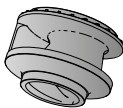

Submersible pumps with single channel impeller in cast iron EN-GJL-250 pag. 259

**GMN**



Submersible pumps with channels impeller in cast iron EN-GJL-250 pag. 268

**GMG**



Submersible pumps with grinder in cast iron EN-GJL-250 pag. 282

**I-GMV**



Submersible pumps with vortex impeller in stainless steel AISI316 pag. 286

**I-GMC**



Submersible pumps with single channel impeller in stainless steel AISI316 pag. 286

**I-GMN**



Submersible pumps with channels impeller in stainless steel AISI316 pag. 286

**B-GMV**



Submersible pumps with vortex impeller in Marine Bronze B10 pag. 297

**B-GMC**

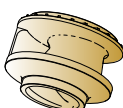

Submersible pumps with single channel impeller in Marine Bronze B10 pag. 297

**B-GMN**



Submersible pumps with channels impeller in Marine Bronze B10 pag. 297

A new series of submersible pumps with high efficiency hydraulics designed to move slurry, sewage and industrial process fluids.

The range covers a wide field of use with head up to 75 m And flows up to 2300 m<sup>3</sup>/h, with a maximum solid passage up to 140 mm keeping the risk of blockage to a minimum. Dimensionally designed for heavy demand, even on critical applications.

Explosion proof version on request.

### Pump designation

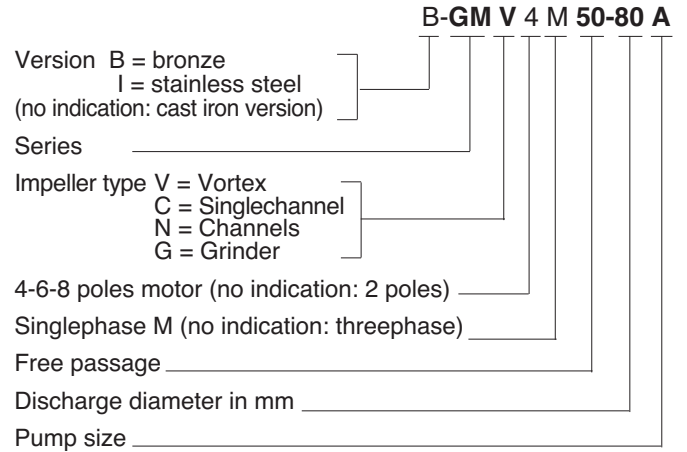

### Coverage chart

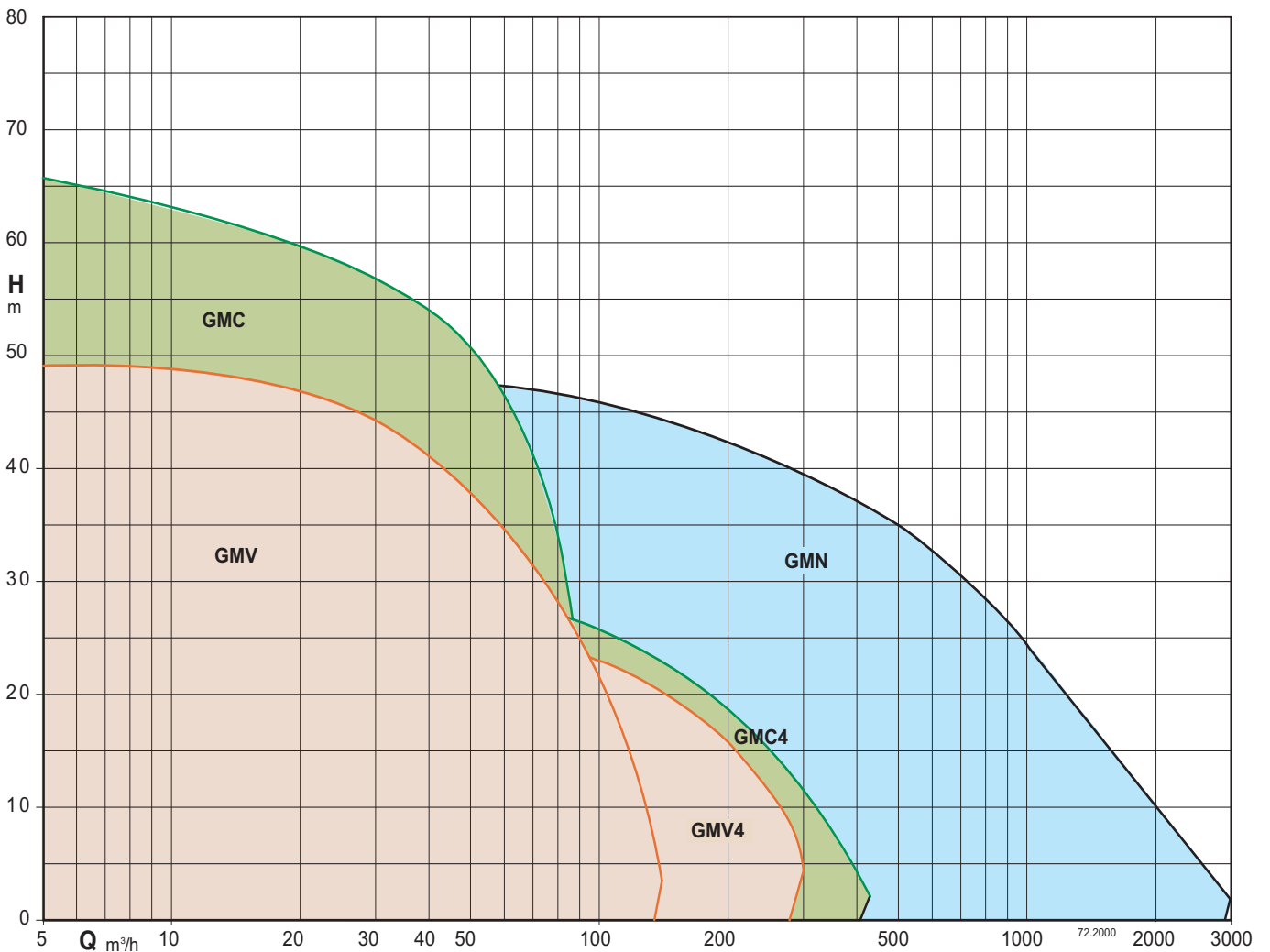

Tolerances according to ISO 9906, annex A.



### Construction

Submersible pumps with single channel impeller.  
Twin mechanical seal with oil chamber (lip-seal motor side up to 1,4 kW).  
Delivery connection DN 50-65-80-100-150

### Applications

Suitable to pump slurry, sewage, waste water (non-corrosive).  
In industrial and residential installations and drainag applications  
Solid passage from 40 to 100mm

### Operating conditions

Liquid temperature up to 40 °C.  
Maximum immersion depth: 20 m (with suitable cable length).  
Continuous duty (with pump immersed at minimum level).

### Motor

2 or 4 poles induction, 50Hz  
Single-phase version: 230V ± 10%, with float switch and built-in capacitor.  
Three-phase version: 400V ± 10%, up to 3,2 kW  
400/690V ± 10%, over 3,2 kW  
Insulation class: H  
Protection degree: IP 68  
N° of starting x hour: max 15 with regular intervals  
Cable: H07RN-F, length 10 m  
Other models: contact our sale office

### Main materials

Pump casing: cast iron EN-GJL-250 - Impeller: cast iron EN-GJL-250+Ni  
Motor casing, Motor cover: cast iron EN-GJL-250  
Motor shaft: stainless steel AISI 420B  
Lip seal made of nitrile up to 1,4 kW  
Mechanical seal motor side: graphite/ceramic over 1,4 kW  
Mechanical seal pump side: silicon carbide/silicon carbide

### Coverage chart

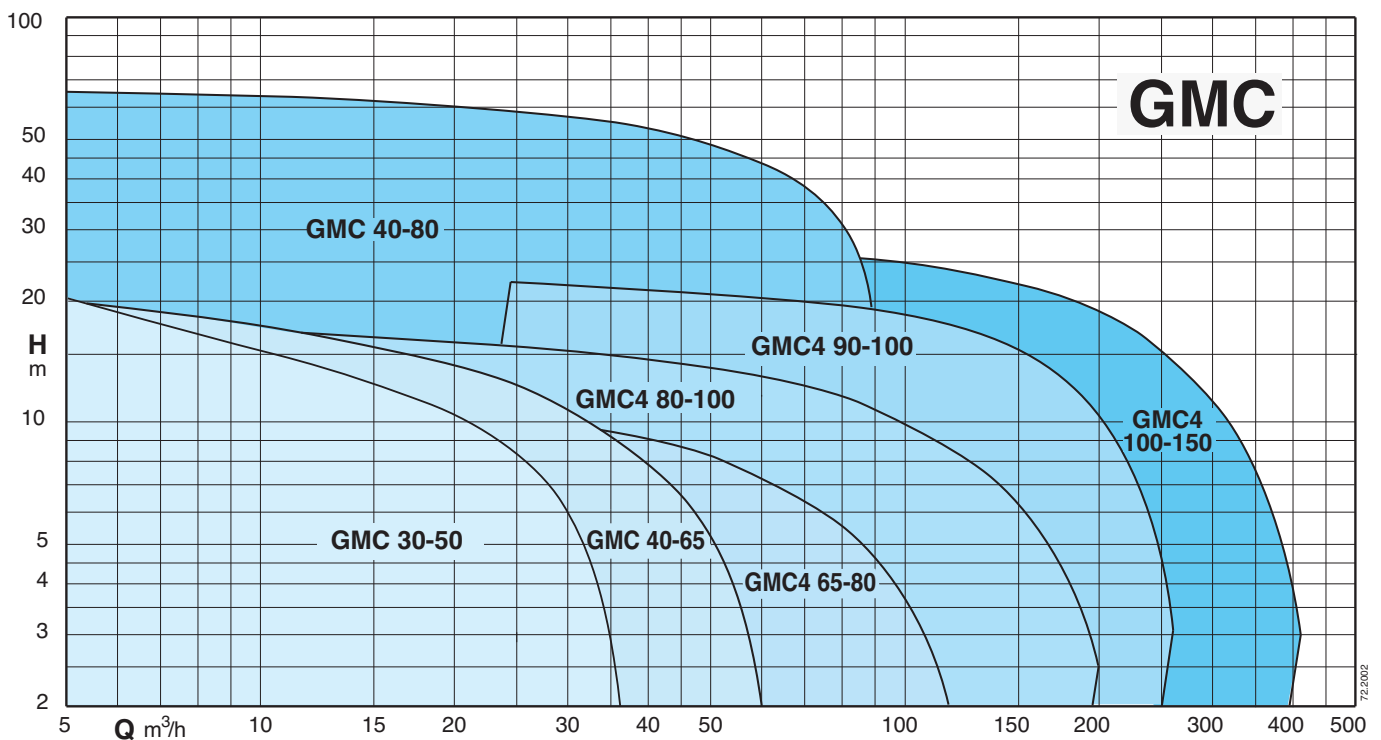

**Technical data**

TYPE	P <sub>2</sub> kW	I <sub>N</sub> A	Power Supply	r.p.m.	Starting	DN mm	Free passage Ø mm	Thermal protector	Humidity probe	ATEX Eex
GCMC 30-50B	1,1	7,5	1~ 230V	2850	D.O.L.	50	30	●	NO	
GMC 30-50B	1,4	3	3~ 400V	2850	D.O.L.	50	30	NO	NO	
GMC 30-50A	1,4	3	3~ 400V	2850	D.O.L.	50	30	NO	NO	
GCMC 40-65B	1,8	10	1~ 230V	2850	D.O.L.	65	40	NO	NO	✓
GMC 40-65B	2,4	5	3~ 400V	2850	D.O.L.	65	40	NO	NO	✓
GMC 40-65A	2,9	6	3~ 400V	2850	D.O.L.	65	40	NO	NO	✓
GMC 40-80D	13,8	29,5	3~ 400/690V	2850	Y/Δ	80	40	●	●	✓
GMC 40-80C	13,8	29,5	3~ 400/690V	2850	Y/Δ	80	40	●	●	✓
GMC 40-80B	18,2	34	3~ 400/690V	2850	Y/Δ	80	40	●	●	✓
GMC 40-80A	18,2	34	3~ 400/690V	2850	Y/Δ	80	40	●	●	✓
GMC4M 65-80C	1,2	8,5	1~ 230V	1450	D.O.L.	80	65	●	NO	✓
GMC4 65-80C	1,3	3,5	3~ 400V	1450	D.O.L.	80	65	NO	NO	✓
GMC4 65-80B	2,3	5	3~ 400V	1450	D.O.L.	80	65	NO	NO	✓
GMC4 65-80A	2,8	6,5	3~ 400V	1450	D.O.L.	80	65	NO	NO	✓
GMC4 75-80A	2,8	6,5	3~ 400V	1450	D.O.L.	80	75	NO	NO	✓
GMC4 80-100C	3,8	8	3~ 400/690V	1450	Y/Δ	100	80	●	●	✓
GMC4 80-100B	3,8	8	3~ 400/690V	1450	Y/Δ	100	80	●	●	✓
GMC4 80-100A	5	11	3~ 400/690V	1450	Y/Δ	100	80	●	●	✓
GMC4 90-100B	11,6	23,2	3~ 400/690V	1450	Y/Δ	100	90	●	●	✓
GMC4 90-100A	14,4	29,5	3~ 400/690V	1450	Y/Δ	100	90	●	●	✓
GMC4 100-150C	14,4	29,5	3~ 400/690V	1450	Y/Δ	150	100	●	●	✓
GMC4 100-150B/A	17,8	32,5	3~ 400/690V	1450	Y/Δ	150	100	●	●	✓
GMC4 100-150A/A	21	43,1	3~ 400/690V	1450	Y/Δ	150	100	●	●	✓

P<sub>2</sub> Rated power output

I<sub>N</sub> Rated current

● Standard

✓ ATEX Eex Version on demand

### Characteristic curves

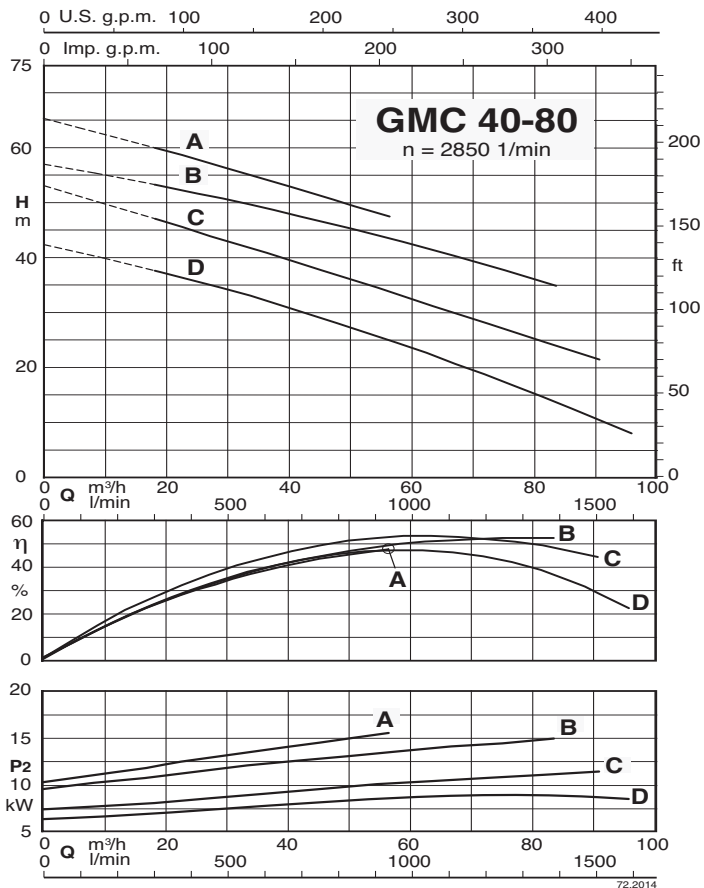
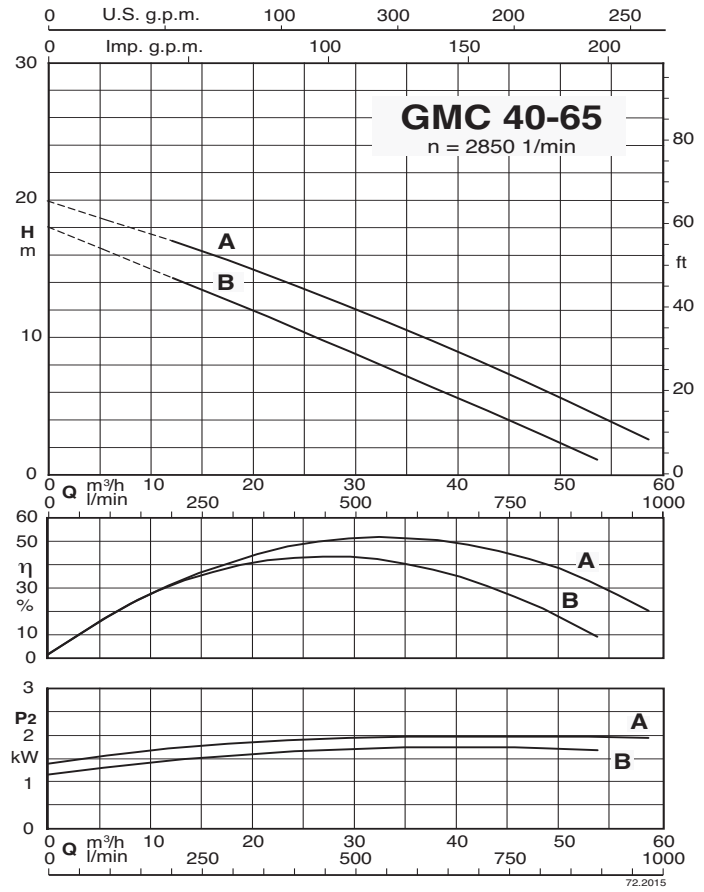
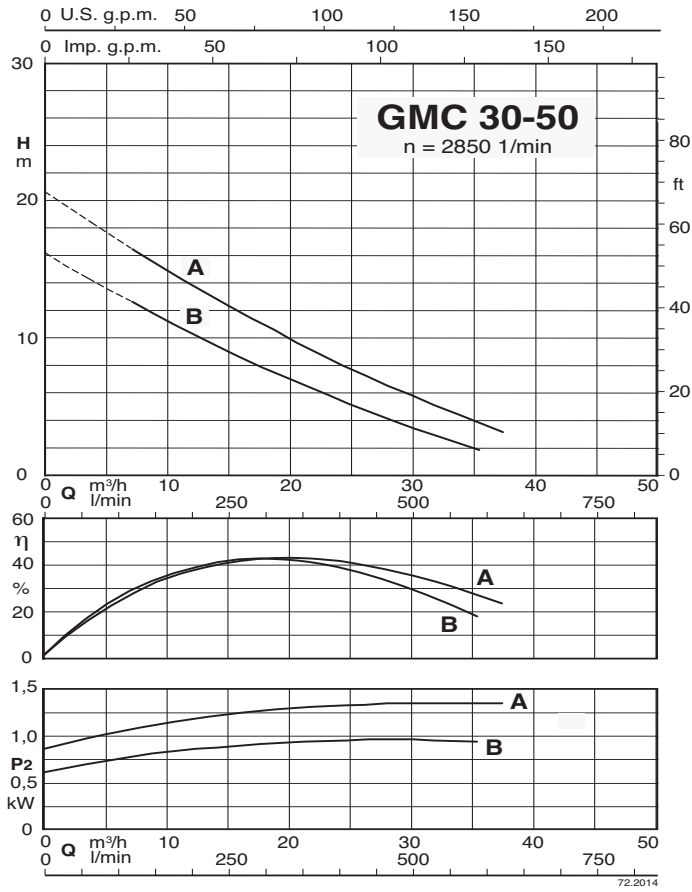

## Characteristic curves

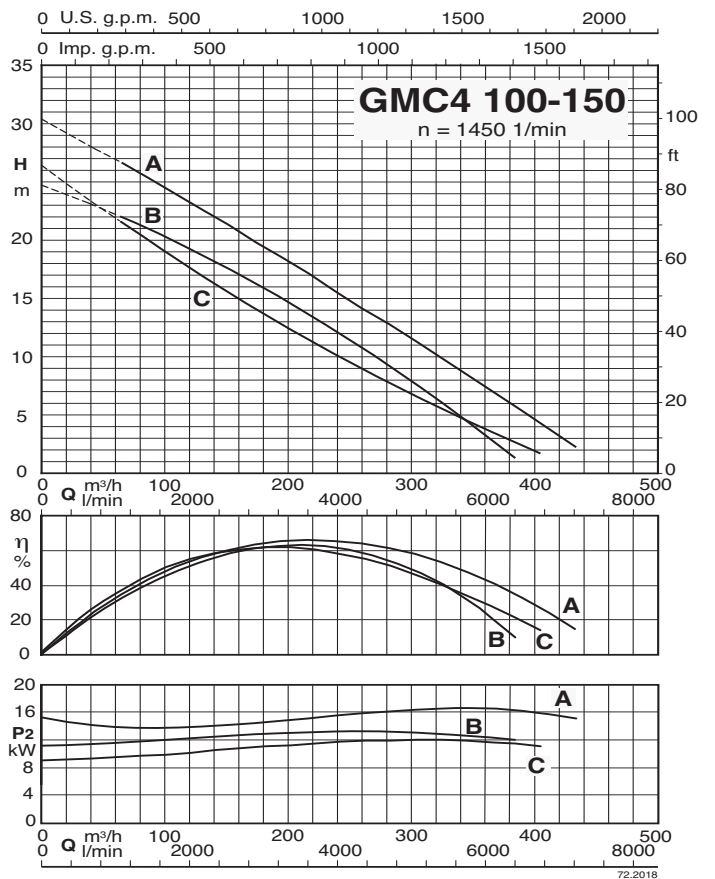
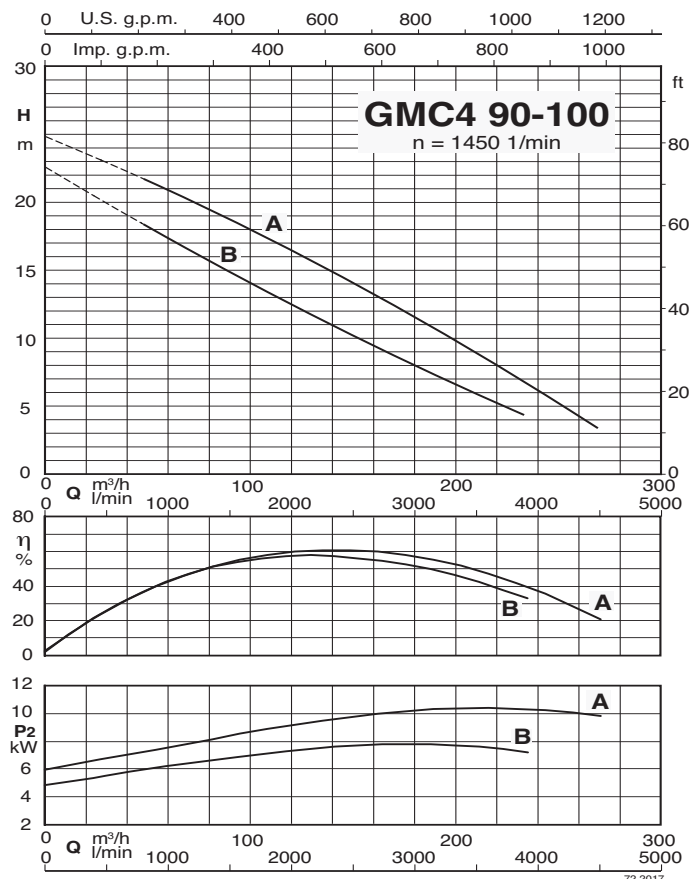
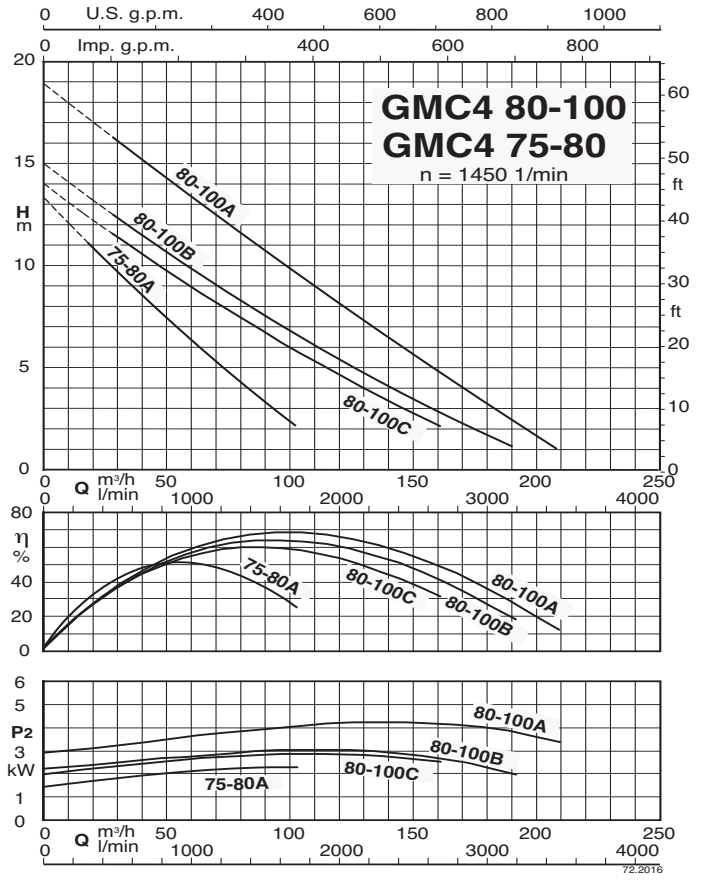
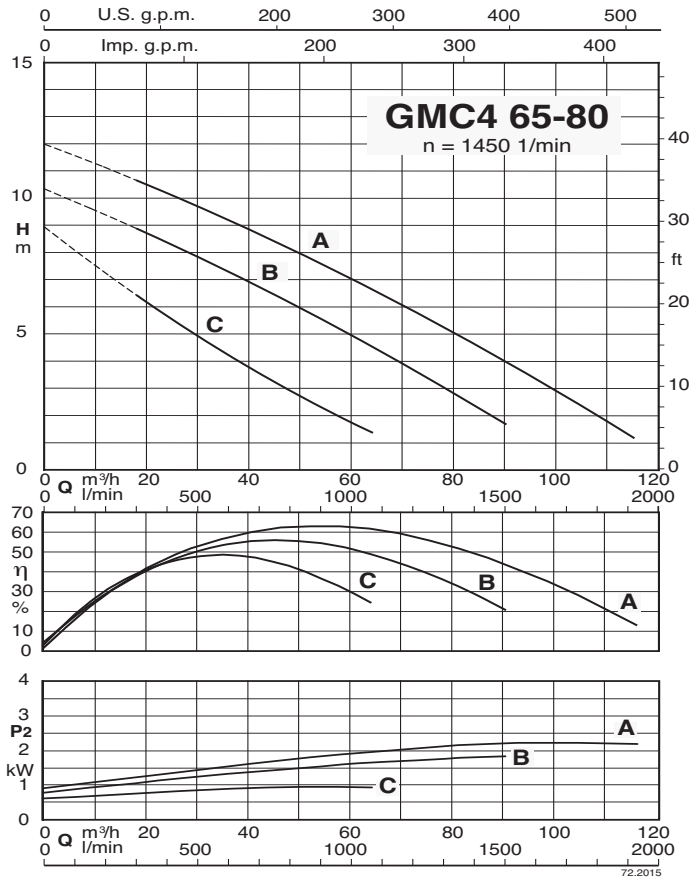

### Dimensions and weights

#### GMC 30-50

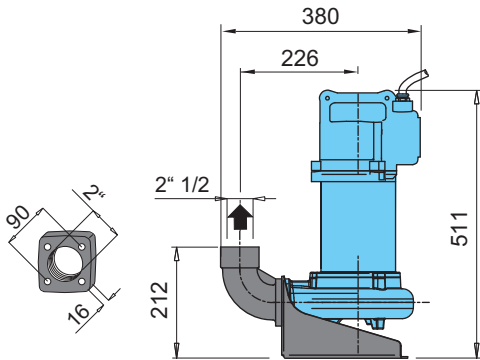
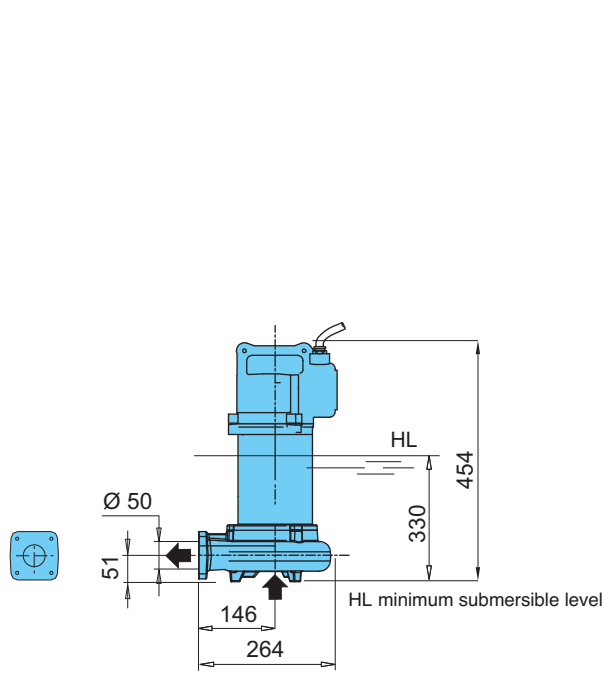

Version with foot and 90° elbow

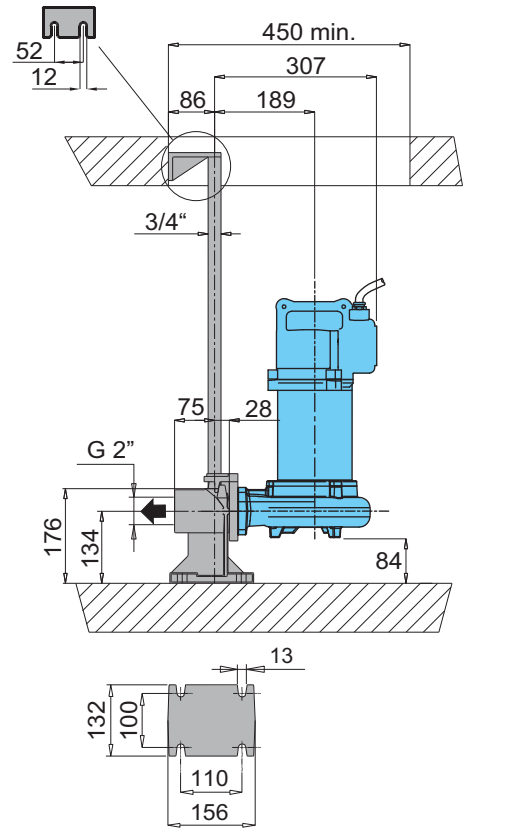

Version with duck foot coupling

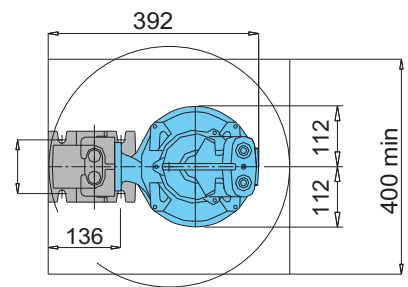

TYPE	Weight kg
GMCM 30-50B	45
GMC 30-50B	
GMC 30-50A	



### Dimensions and weights

#### GMC 40-65

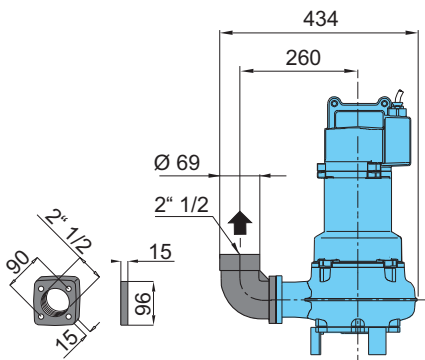
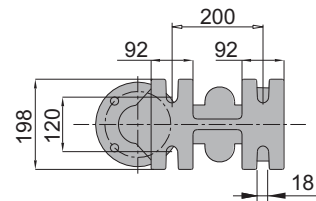
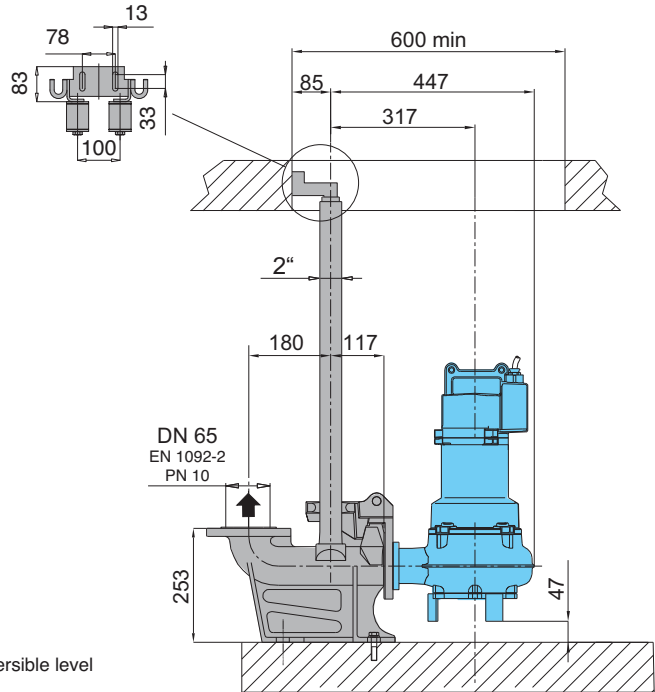
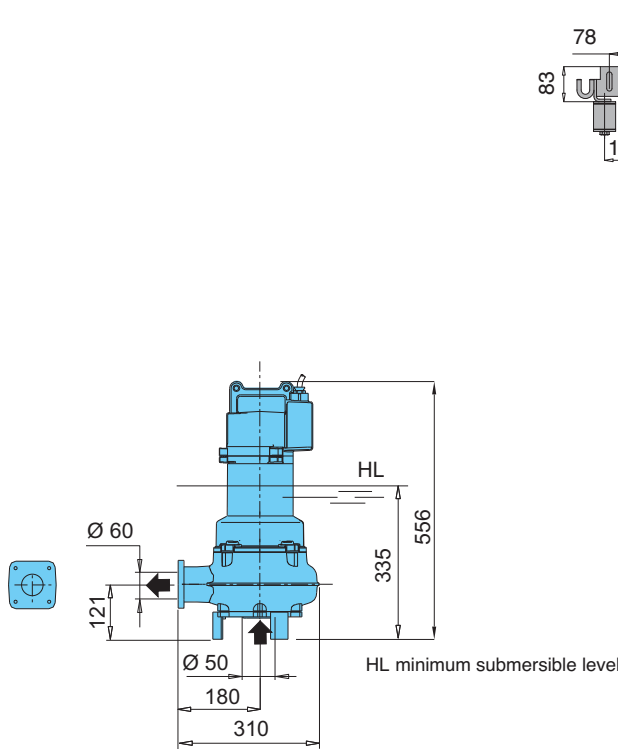

Version with foot and 90° elbow

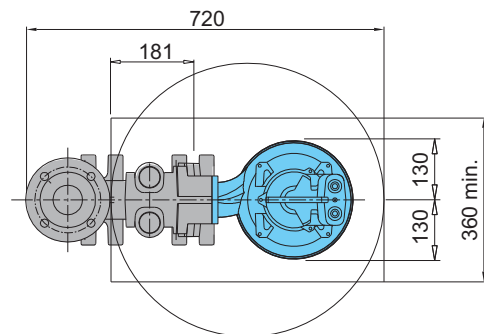

Version with duck foot coupling

TYPE	Weight kg
GMCM 40-65B	45
GMC 40-65B	
GMC 40-65A	

### Dimensions and weights

- GMC 40-80**
- GMC4M 65-80**
- GMC4 65-80**
- GMC4 75-80**

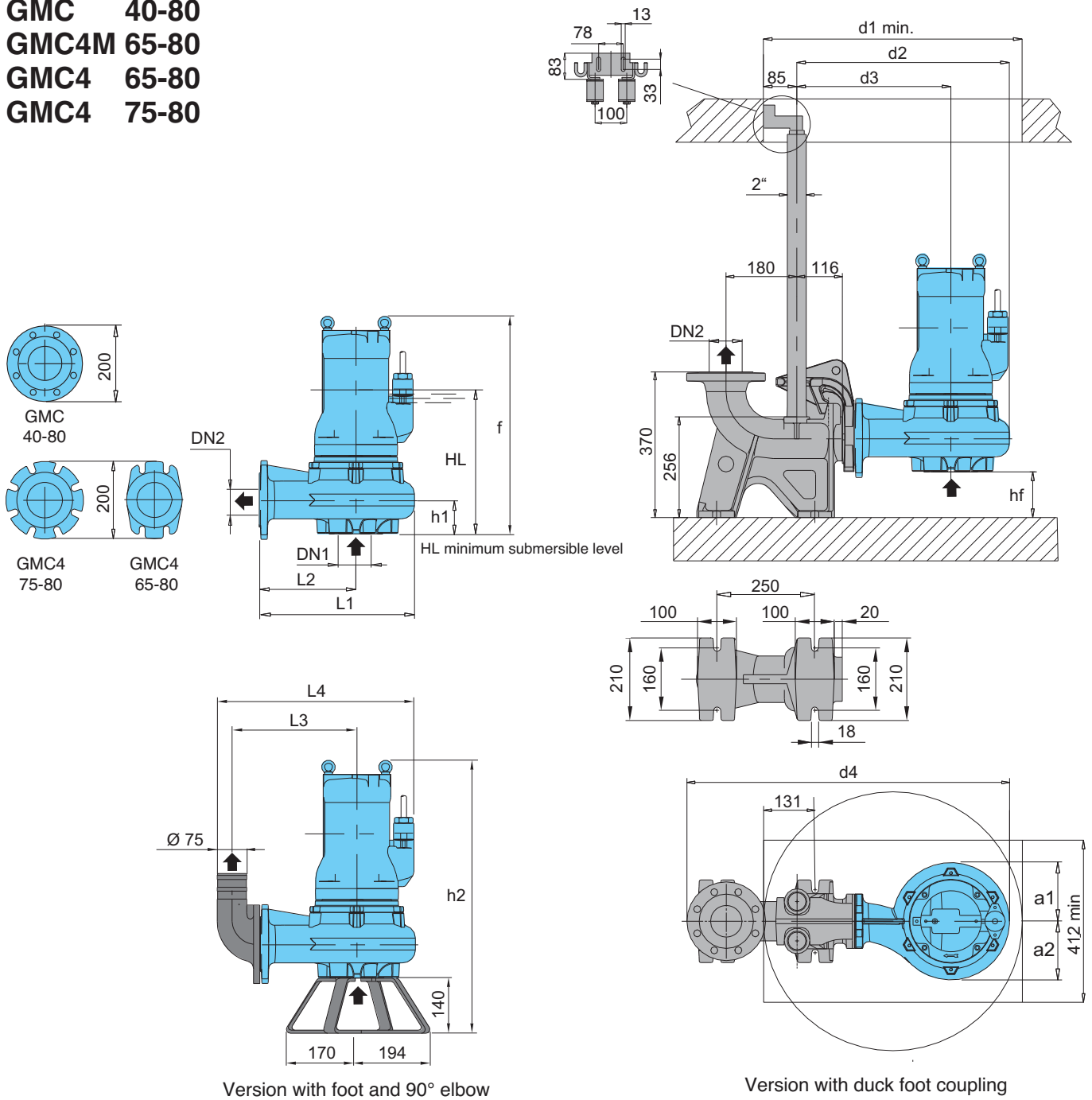

TYPE	EN 1092-2 PN 10		Dimensions mm														Weight kg	
	DN1	DN2	f	HL	hf	h1	h2	a1	a2	d1	d2	d3	d4	L1	L2	L3		L4
GMC 40-80D	80	80	890	523	85	116	1040	168	168	750	603	416	883	437	250	323	547	190
GMC 40-80C																		
GMC 40-80B																		
GMC 40-80A																		
GMC4M 65-80C	80	80	533	330	104	100	673	132	132	658	498	366	775	332	200	273	442	49
GMC4 65-80C																		
GMC4 65-80B																		
GMC4 65-80A																		
GMC4 75-80A	80	80	519	360	84	116	659	136	157	658	511	366	791	365	220	293	475	67
GMC4 75-80A	80	80	516	380	80	121	656	143	169	700	548	396	828	402	250	323	512	66

### Dimensions and weights

#### GMC4 80-100

#### GMC4 90-100

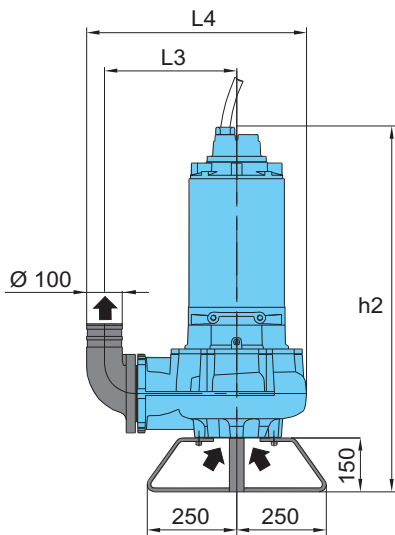
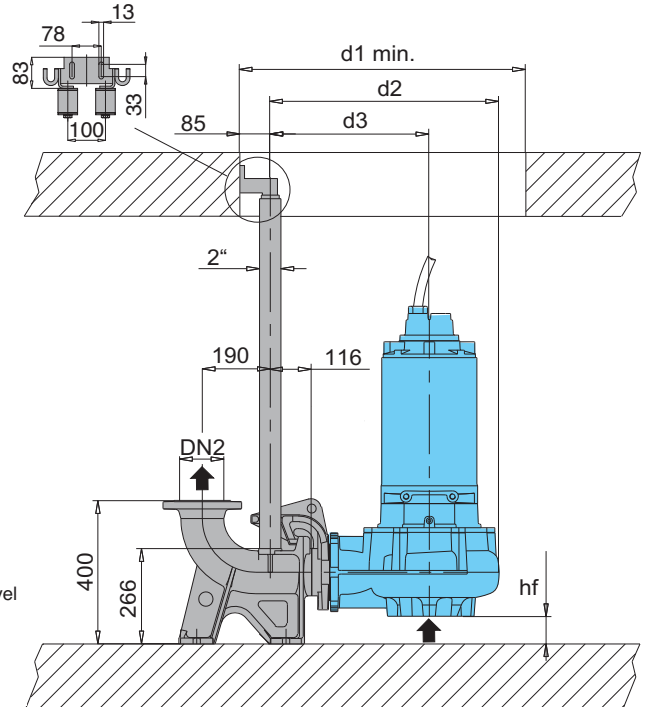
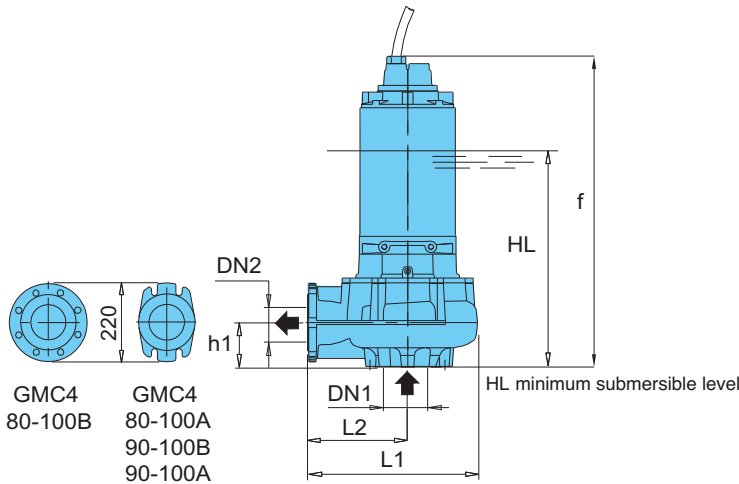

Version with foot and 90° elbow

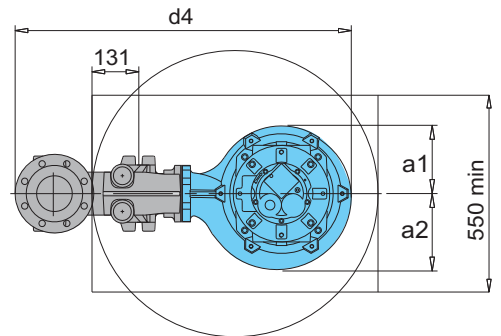
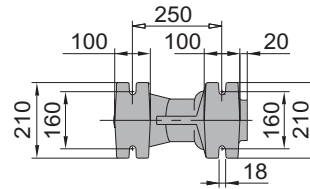

Version with duck foot coupling

TYPE	EN 1092-2 PN 10		Dimensions mm																Weight kg
	DN1	DN2	f	HL	hf	h1	h2	a1	a2	d1	d2	d3	d4	L1	L2	L3	L4		
GMC4 80-100C GMC4 80-100B	125	100	597	420	62	138	747	180	231	850	673	466	973	507	300	390	647	117	
GMC4 80-100A	125	100	852	520	54	147	1002	189	212	800	640	445	940	474	279	369	614	161	
GMC4 90-100B GMC4 90-100A	125	100	920	570	54	147	1070	189	212	800	640	445	940	474	279	369	614	204	

### Dimensions and weights

#### GMC4 100-150

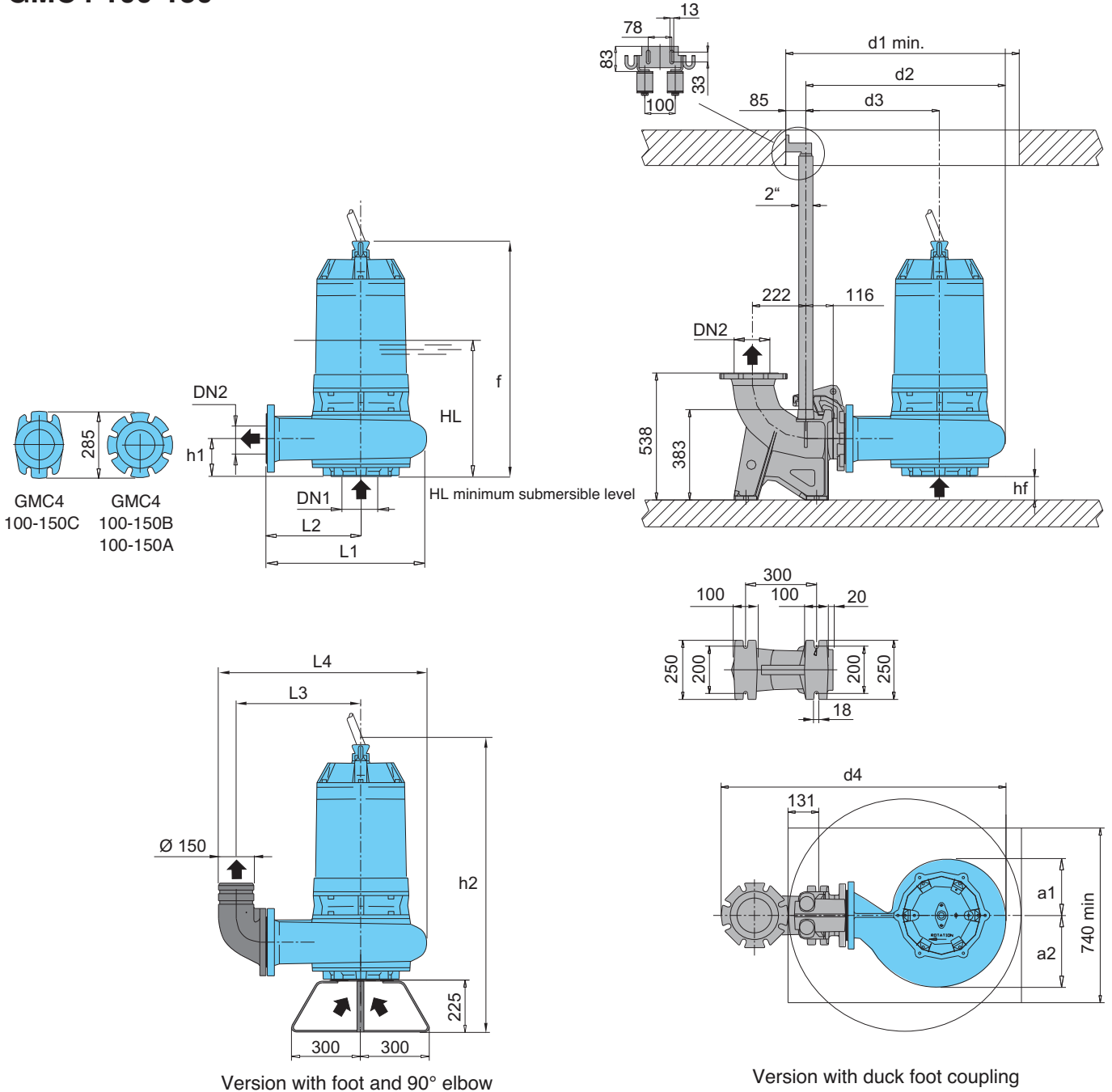

TYPE	EN 1092-2 PN 10		Dimensions mm														Weight kg	
	DN1	DN2	f	HL	hf	h1	h2	a1	a2	d1	d2	d3	d4	L1	L2	L3		L4
GMC4 100-150C	150	150	933	580	113	147	1155	191	223	850	673	467	1038	507	301	431	712	218
GMC4 100-150B/A	150	150	1354	660	80	180	1494	239	304	990	840	566	1208	673	400	530	875	375
GMC4 100-150A/A			1410	760			1632											