



Construction

Pump casing with suction and delivery connections with the same diameter and on the same axis (in-line).

Materials:

| | |
|-------------|-----------------|
| Pump casing | Cast iron |
| Impeller | Stainless steel |
| Shaft | Stainless steel |

Applications

For clean liquids, without abrasives, which are non-aggressive for the pump materials (contents of solids up to 0.2%).

For heating, conditioning, cooling and circulation plants.

For civil and industrial applications.

When low noise operation is required.

Operating conditions

Liquid temperature from -10 °C to +120 °C (in short-time duty up to +140 °C).

Ambient temperature up to 40 °C.

Maximum glycol quantity: 50% (Mixture with more than 20% glycol content require rechecking of the pumping data).

Maximum permissible working pressure 6/10 bar.

| TYPE | Minimum suction pressure: bar | | |
|--------|-------------------------------|-------|--------|
| | Temperature | | |
| | 50 °C | 80 °C | 110 °C |
| NCD 40 | 0,05 | 0,8 | 1,4 |
| NCD 50 | 0,3 | 1 | 1,6 |
| NCD 65 | 0,3 | 1 | 1,6 |
| NCD 80 | 0,3 | 1 | 1,6 |

Motor

2-4-pole induction motor, 50 Hz.
Three adjustable speeds.

NCD: three-phase 230V or 400 V.

NCDM: single-phase 230 V.

Insulation class H.

Protection IP 43.

Operation

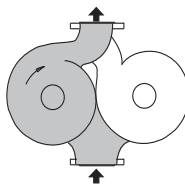

Single operation

Operation of a single pump choosed by the customer, with the second pump on stand-by

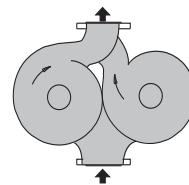

Double operation

Operation in parallel of the two pumps

Installation

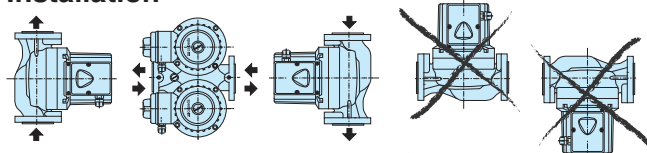

Cross section drawings

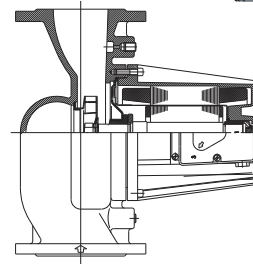

Designation

NC D (M) 4 40 - 60 / 250

| | |
|--------------------|---------|
| Series | NC |
| Twin pumps version | D |
| Single-phase motor | (M) |
| 4-pole motor | 4 |
| DN ports in mm | 40 - 60 |
| Max. head in dm | / 250 |
| connection size mm | |

Coverage chart

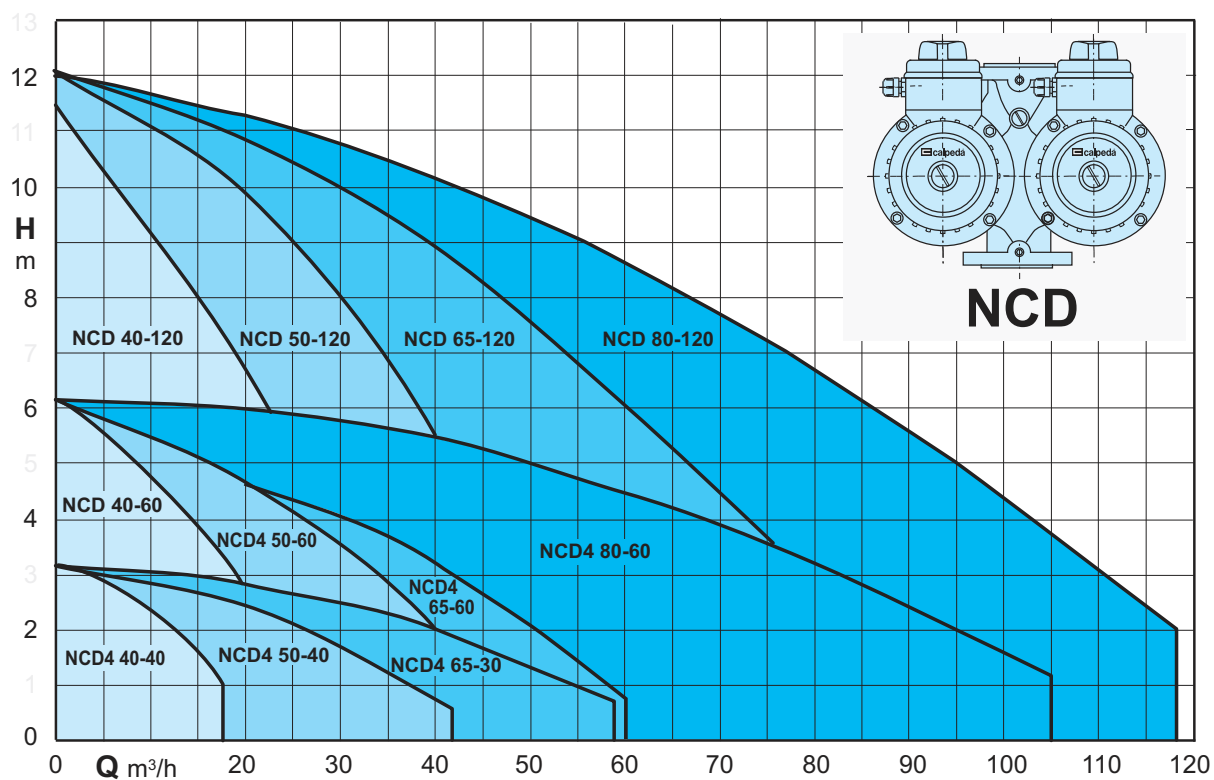

Tolerances according to ISO 9906, annex A.

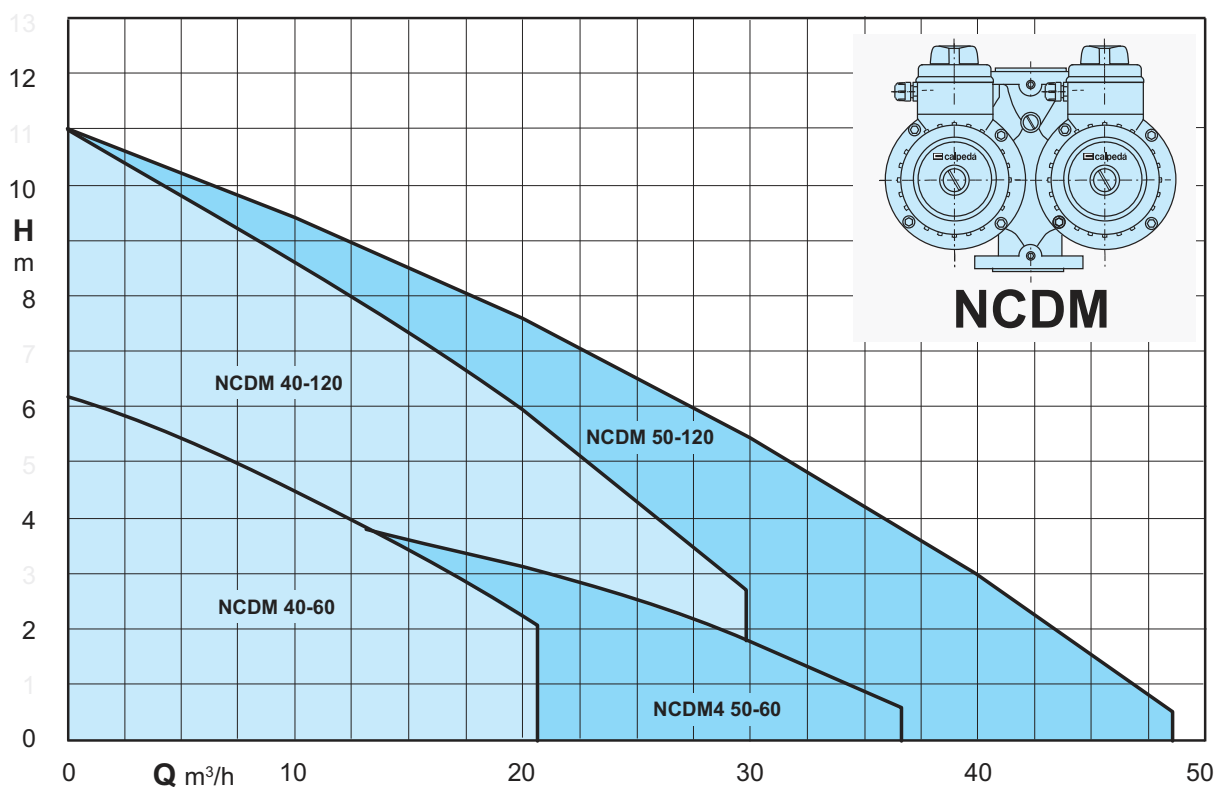

Tolerances according to ISO 9906, annex A.

Characteristic curves, dimensions and weights

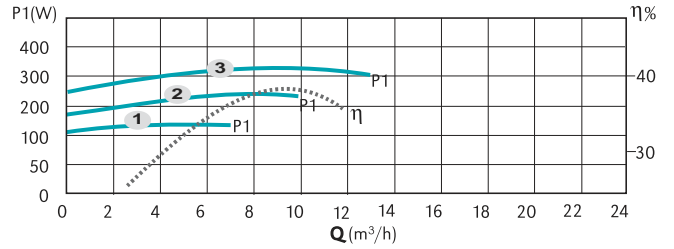
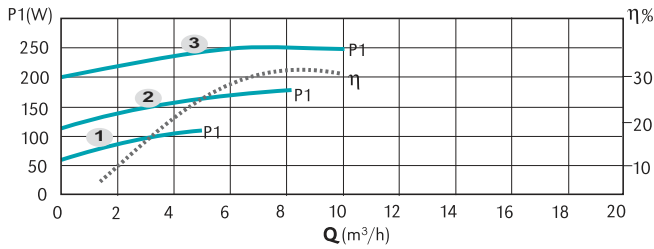
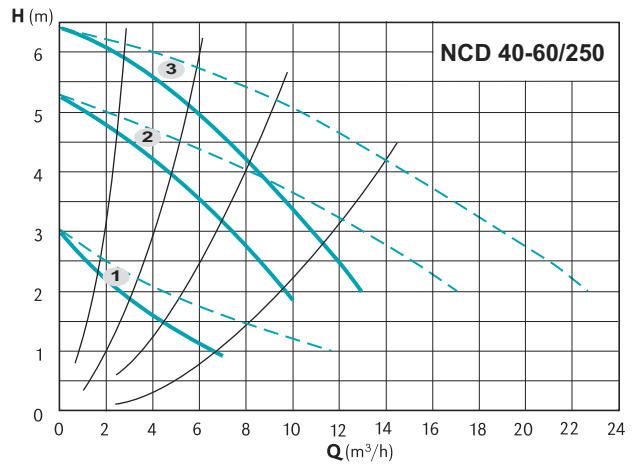
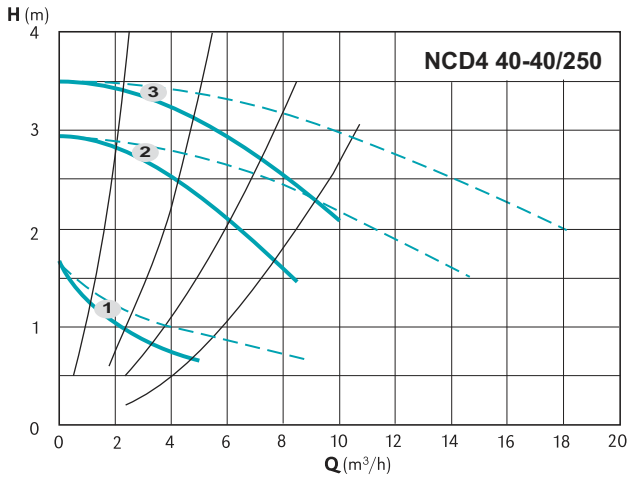

— Single operation
- - - Operation in parallel

— Single operation
- - - Operation in parallel

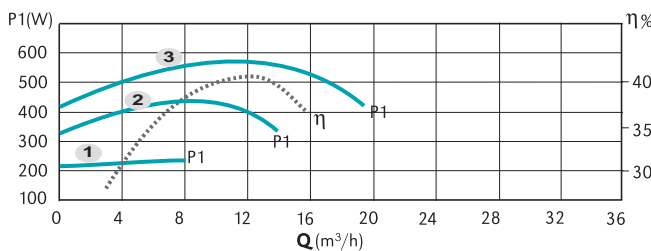
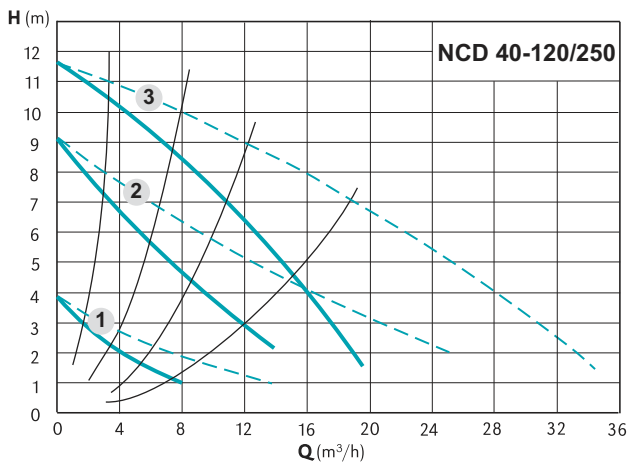

— Single operation
- - - Operation in parallel

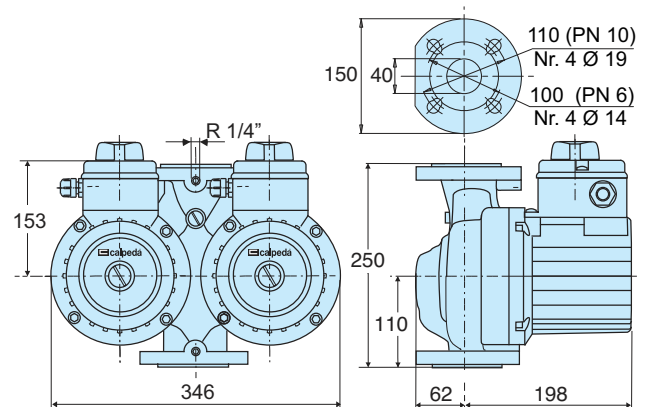

| TYPE | DN | PN | N° Poli | | Pos. | 1/min | P1 (W) | 3x 400 V | |
|----------------|----|------|---------|---|------|-------|--------|----------|------|
| | | | 2 | 4 | | | | [A] | [kg] |
| NCD4 40-40/250 | 40 | 6/10 | ✓ | | 3 | 1440 | 240 | 0,76 | 34,0 |
| | | | | | 2 | 1200 | 160 | 0,24 | |
| | | | | | 1 | 660 | 100 | 0,11 | |
| NCD 40-60/250 | 40 | 6/10 | ✓ | | 3 | 2790 | 320 | 0,74 | 35,0 |
| | | | | | 2 | 2240 | 240 | 0,36 | |
| | | | | | 1 | 1440 | 140 | 0,18 | |
| NCD 40-120/250 | 40 | 6/10 | ✓ | | 3 | 2820 | 560 | 1,16 | 35,0 |
| | | | | | 2 | 2200 | 400 | 0,64 | |
| | | | | | 1 | 1250 | 220 | 0,26 | |

Characteristic curves, dimensions and weights

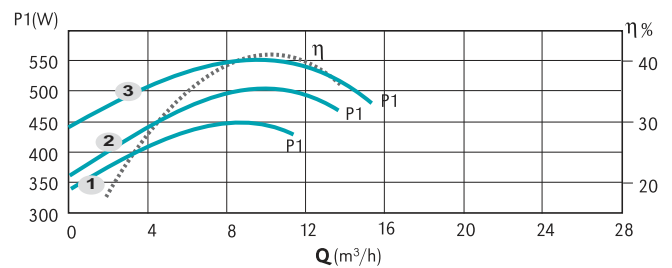
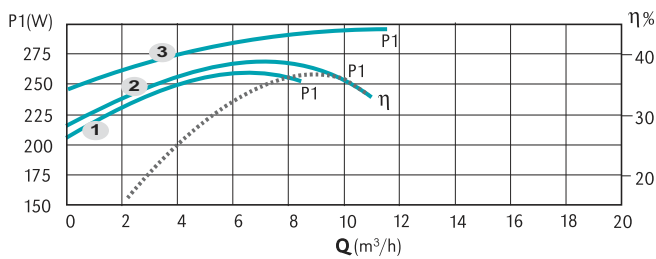
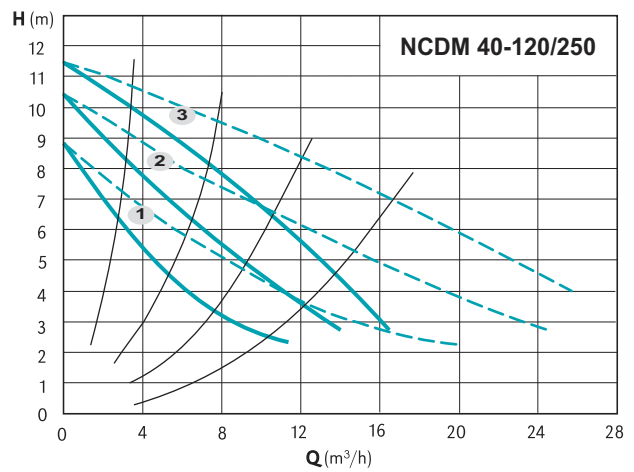
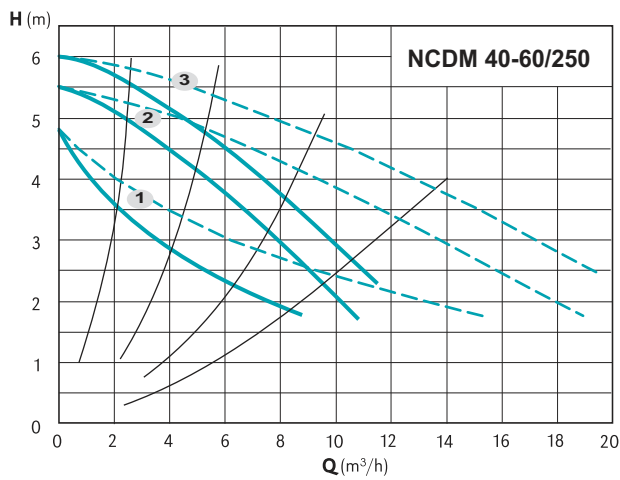

— Single operation
- - - Operation in parallel

— Single operation
- - - Operation in parallel

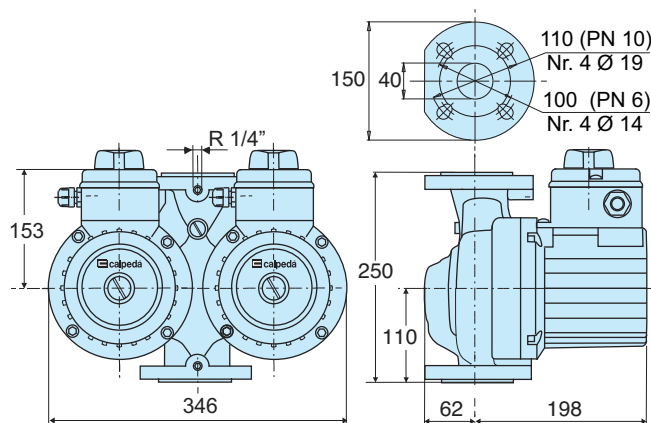

| TYPE | DN PN | | N° Poli 2 4 | Pos. | 1/min | P1 (W) | 1x 230 V [A] | [kg] |
|-----------------|---------|------|------------------|------|-------|-----------|--------------------|------|
| | DN | PN | | | | | | |
| NCDM 40-60/250 | 40 | 6/10 | ✓ | 3 | 2690 | 285 | 1,20 | 35,0 |
| | | | | 2 | 2360 | 245 | 1,18 | |
| | | | | 1 | 1820 | 225 | 1,15 | |
| NCDM 40-120/250 | 40 | 6/10 | ✓ | 3 | 2755 | 550 | 2,35 | 35,0 |
| | | | | 2 | 2100 | 475 | 2,30 | |
| | | | | 1 | 1270 | 355 | 1,85 | |

Characteristic curves, dimensions and weights

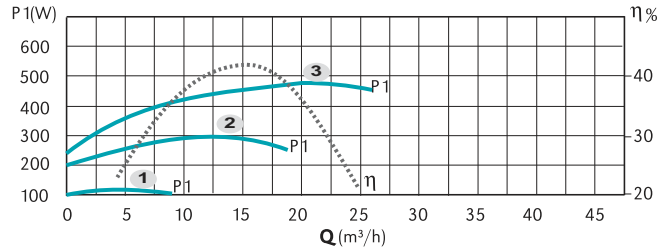
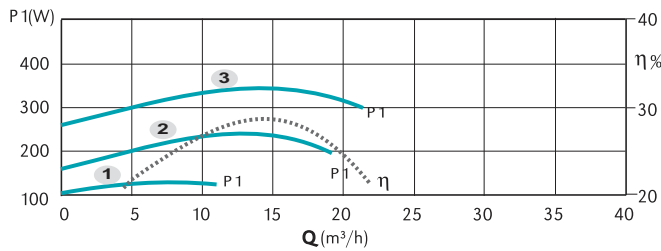
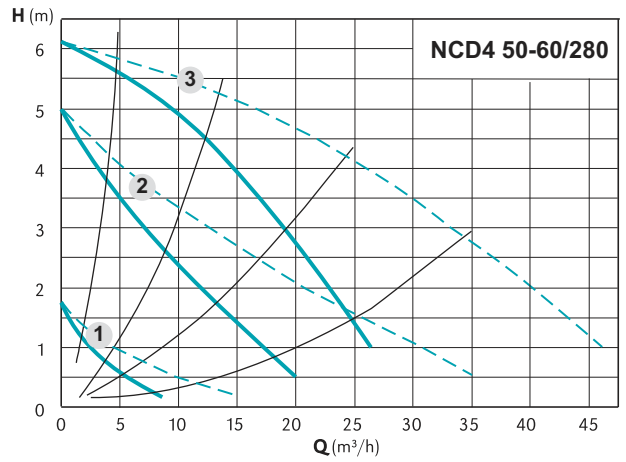
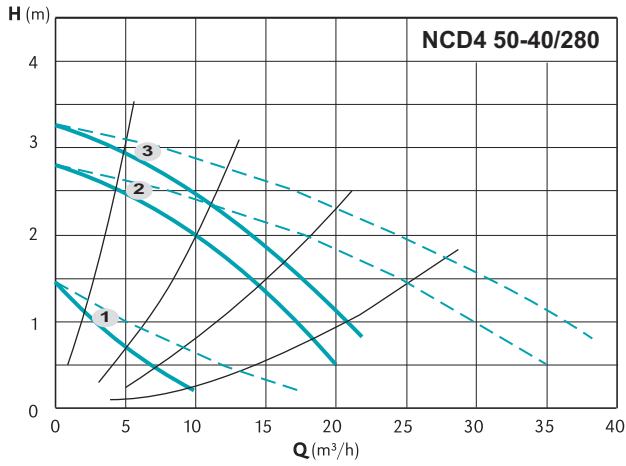

— Single operation
- - - Operation in parallel

— Single operation
- - - Operation in parallel

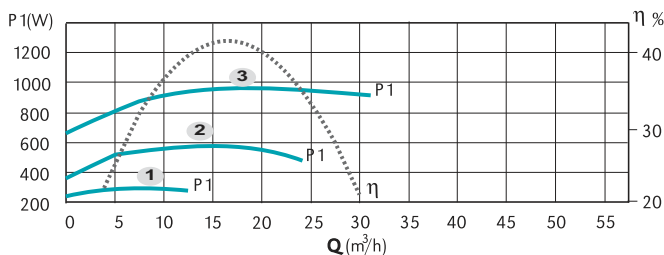
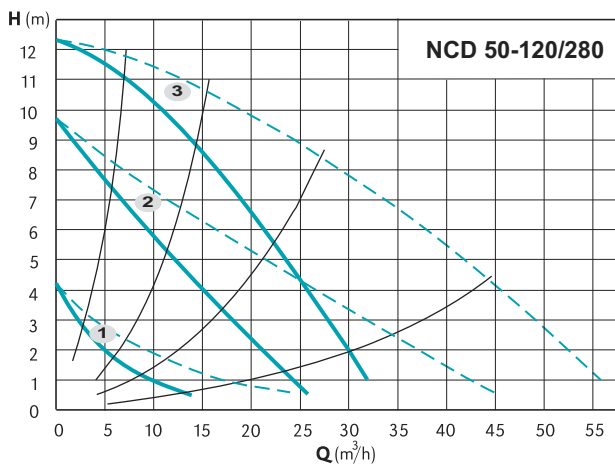

— Single operation
- - - Operation in parallel

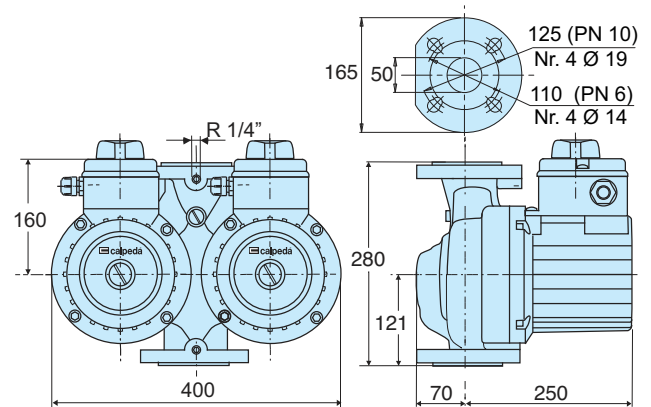

| TYPE | DN | PN | N° Poli 2 4 | Pos. | 1/min | P1 (W) | 3x 400 V [A] | [kg] |
|----------------|----|------|------------------|------|-------|-----------|--------------------|------|
| NCD4 50-40/280 | 50 | 6/10 | ✓ | 3 | 1450 | 340 | 1,05 | 44,0 |
| | | | | 2 | 1220 | 240 | 0,44 | |
| | | | | 1 | 620 | 120 | 0,22 | |
| NCD4 50-60/280 | 50 | 6/10 | ✓ | 3 | 1400 | 470 | 1,15 | 44,0 |
| | | | | 2 | 1000 | 300 | 0,55 | |
| | | | | 1 | 560 | 100 | 0,20 | |
| NCD 50-120/280 | 50 | 6/10 | ✓ | 3 | 2800 | 950 | 1,73 | 44,0 |
| | | | | 2 | 2330 | 540 | 1,05 | |
| | | | | 1 | 1270 | 265 | 0,46 | |

Characteristic curves, dimensions and weights

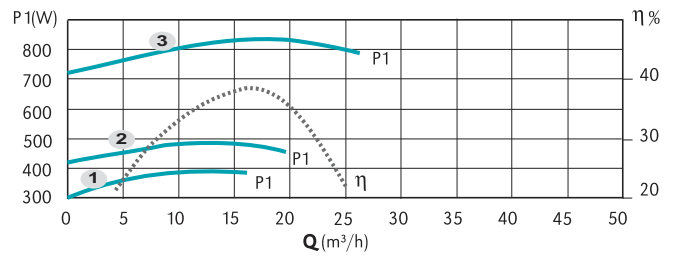
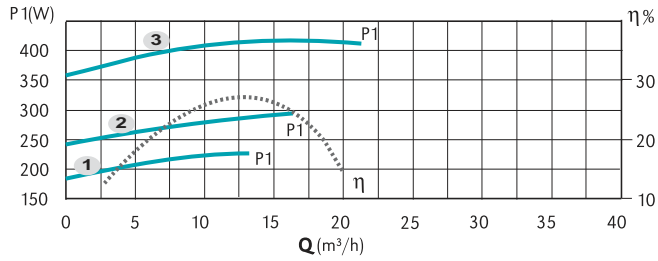
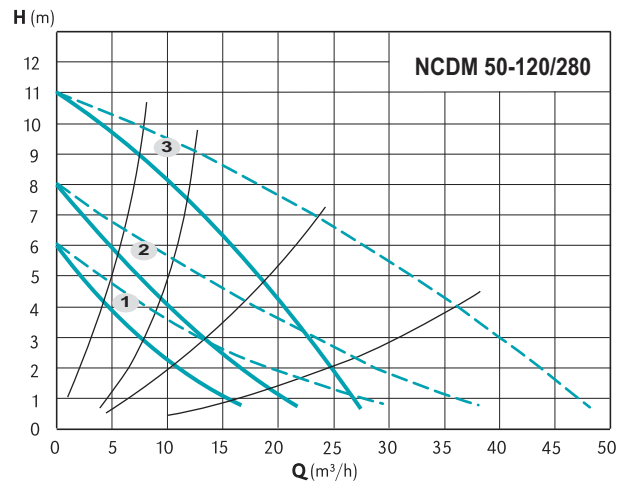
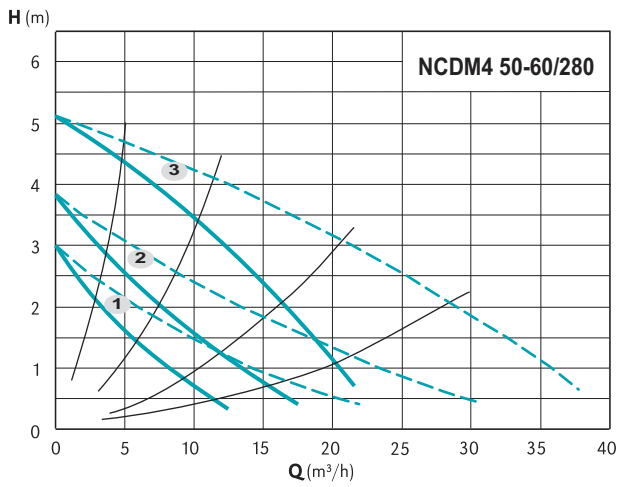

——— Single operation
- - - - - Operation in parallel

——— Single operation
- - - - - Operation in parallel

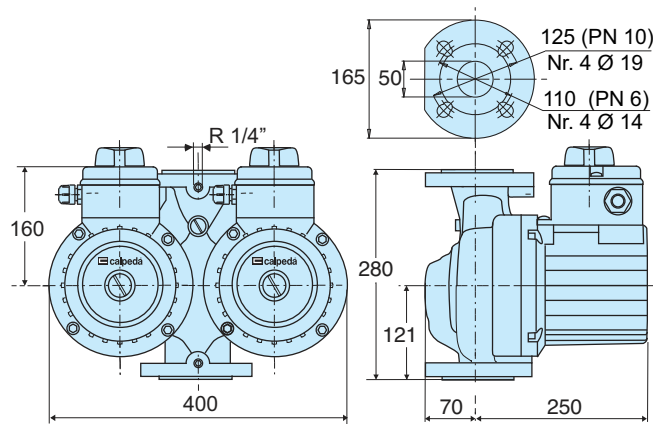

| TYPE | DN | PN | N° Poli | | Pos. | 1/min | P1 (W) | 1x 230 V [A] | [kg] |
|-----------------|----|------|---------|---|------|-------|--------|--------------|------|
| | | | 2 | 4 | | | | | |
| NCDM4 50-60/280 | 50 | 6/10 | ✓ | 3 | 1260 | 415 | 1,8 | 44,0 | |
| | | | | 2 | 1030 | 300 | 1,3 | | |
| | | | | 1 | 740 | 230 | 1,0 | | |
| NCDM 50-120/280 | 50 | 6/10 | ✓ | 3 | 2720 | 830 | 3,6 | 44,0 | |
| | | | | 2 | 1870 | 480 | 2,1 | | |
| | | | | 1 | 1450 | 390 | 1,7 | | |

Characteristic curves, dimensions and weights

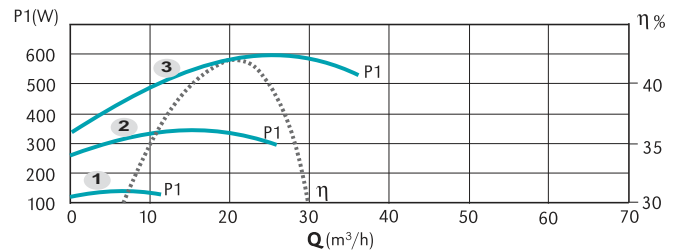
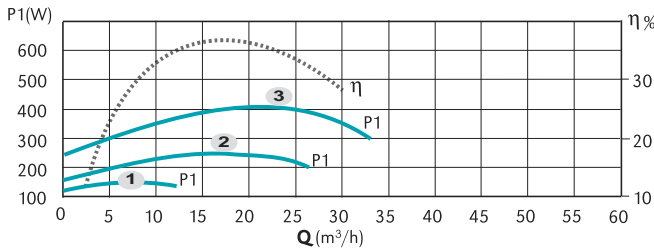
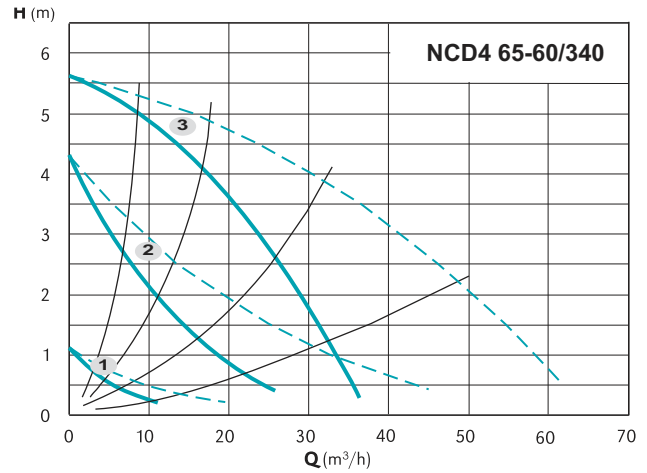
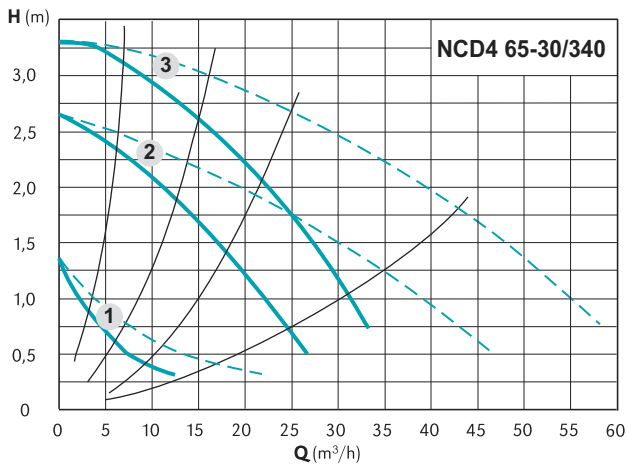

— Single operation
- - - Operation in parallel

— Single operation
- - - Operation in parallel

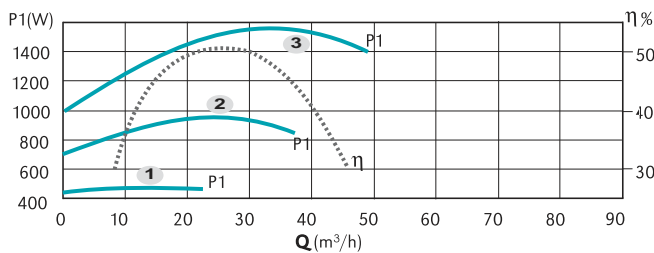
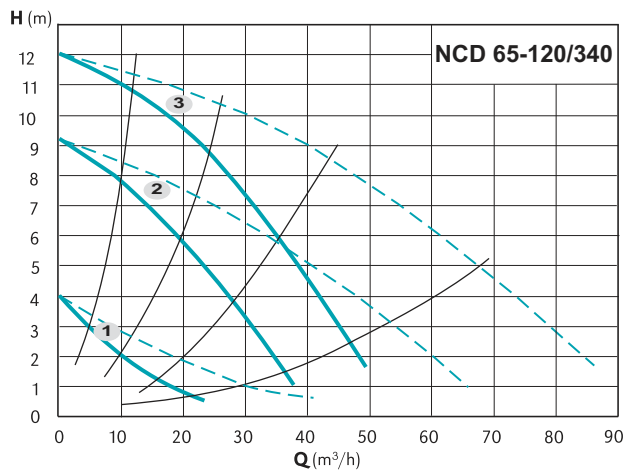

— Single operation
- - - Operation in parallel

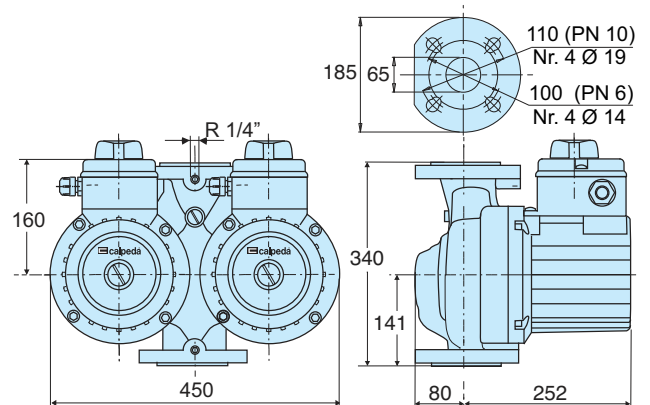

| TYPE | DN | PN | N° Poli 2 4 | Pos. | 1/min | P1 (W) | 3x 400 V [A] | [kg] |
|----------------|----|------|------------------|------|-------|-----------|--------------------|------|
| NCD4 65-30/340 | 65 | 6/10 | ✓ | 3 | 1430 | 400 | 1,10 | 49,0 |
| | | | | 2 | 1150 | 260 | 0,50 | |
| | | | | 1 | 600 | 120 | 0,22 | |
| NCD4 65-60/340 | 65 | 6/10 | ✓ | 3 | 1370 | 600 | 1,25 | 49,0 |
| | | | | 2 | 950 | 360 | 0,64 | |
| | | | | 1 | 450 | 120 | 0,22 | |
| NCD 65-120/340 | 65 | 6/10 | ✓ | 3 | 2810 | 1560 | 2,80 | 54,0 |
| | | | | 2 | 2200 | 960 | 1,70 | |
| | | | | 1 | 1250 | 460 | 0,84 | |

Characteristic curves, dimensions and weights

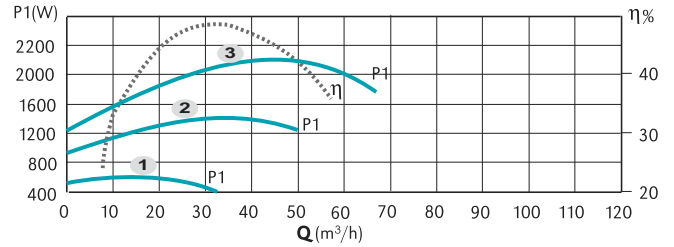
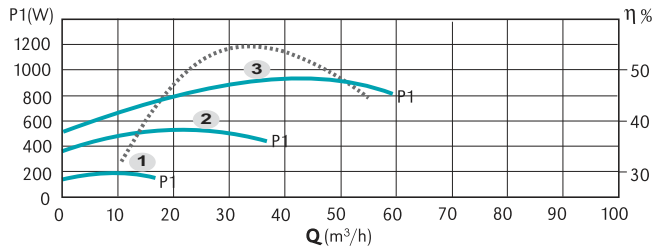
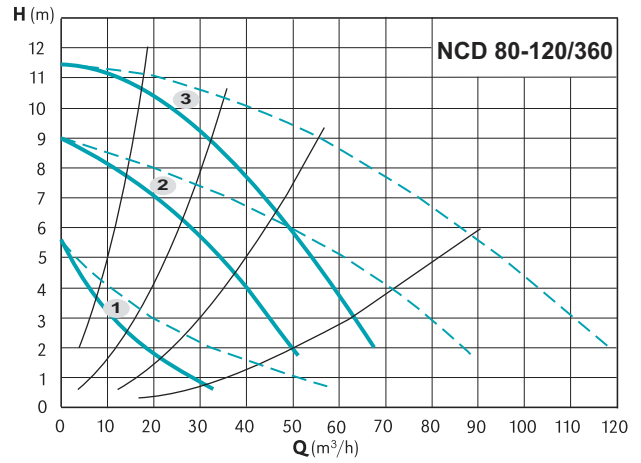
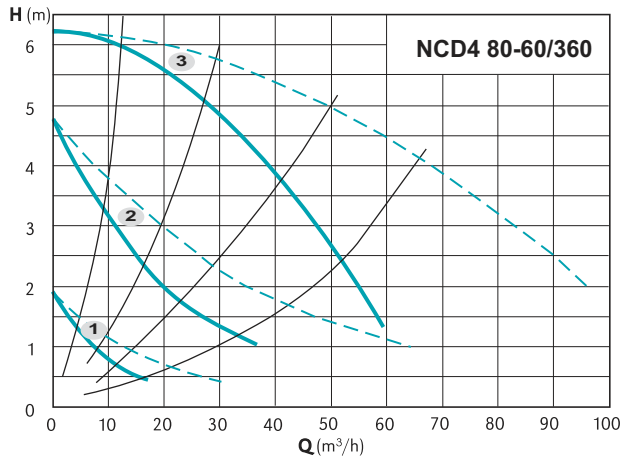

——— Single operation
- - - - - Operation in parallel

——— Single operation
- - - - - Operation in parallel

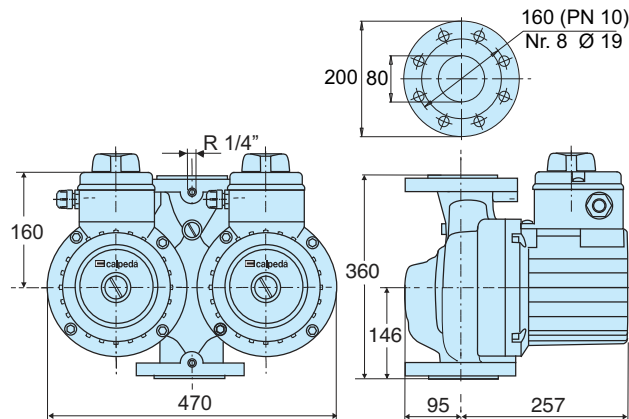

| TYPE | DN PN | | N° Poli 2 4 | Pos. | 1/min | P1 (W) | 3x 400 V [A] | [kg] |
|----------------|-------|----|----------------|------|-------|-----------|--------------------|------|
| | DN | PN | | | | | | |
| NCD4 80-60/360 | 80 | 10 | ✓ | 3 | 1350 | 960 | 2,20 | 60,0 |
| | | | | 2 | 1000 | 560 | 1,10 | |
| | | | | 1 | 600 | 200 | 0,38 | |
| NCD 80-120/360 | 80 | 10 | ✓ | 3 | 2800 | 2200 | 3,80 | 62,0 |
| | | | | 2 | 2160 | 1400 | 2,40 | |
| | | | | 1 | 1200 | 550 | 1,05 | |